

SH SERIES 18



- V-BELT TRANSMISSION
- AUTOMATIC TAPPING FEED
- FIXED TABLE, SLIDING AND ROTATING HEADSTOCK
- CAST IRON HEAD, BASE, AND COLUMN



[+]

- Standard spindle, automatic tapping
- 1 Standard spindle included, pitch to be determined
- Table with "T" slots
- Adjustable depth end
- Lighting equipment
- Tool ejector
- Belt cover with stop micro
- Motor guard
- Emergency push button
- Main switch
- Manual/automatic cycle selector
- Single/continuous cycle selector
- Adjustable stops and microswitches: depth, reversal, and stop
- Variator brake device
- Electrical equipment at low voltage
- Electrical equipment in a separate cabinet
- Drill guard with stop micro
- CE norms

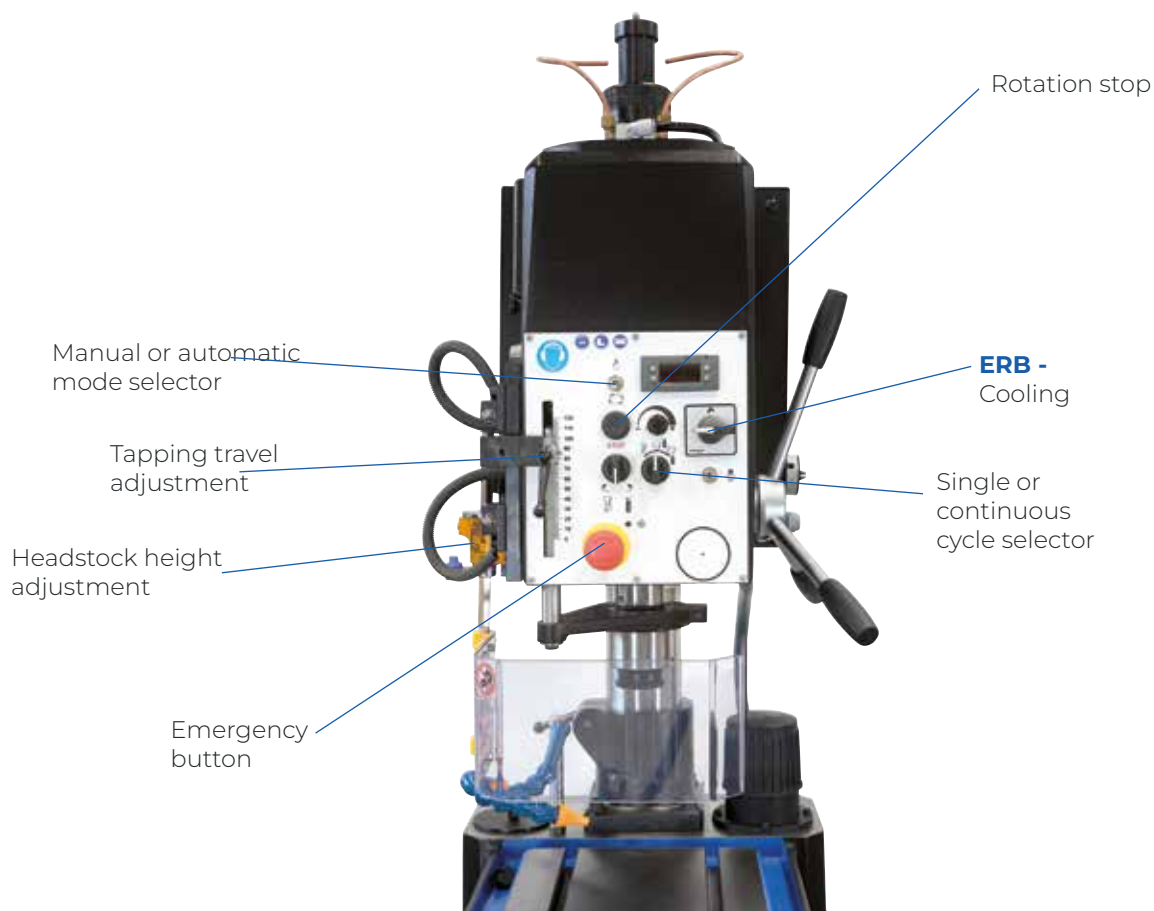

FEATURES		SH.18
Maximum drilling capacity in steel 50/60	Ø mm	18
Maximum tapping capacity in steel 50/60		M14
Morse cone	Num.	3
Maximum spindle stroke (drilling depth)	mm	90
Main motor power	KW	1.12
Transmission		V-belts
Number and range of speeds (without variator)	rpm	10 (245-355-490-710-835-1240-1670-2000-2480-4000)
Feed		Manual
Worktable dimensions (LxW)	mm	270 x 270
Column diameter	mm	100
Distance from the spindle centre to the face of the column	mm	250
Net weight <i>Without and with intermediate table</i>	kg	190/240
Gross weight with packaging <i>Without and with intermediate table</i>	kg	200/260
Packaging dimensions (length x width x height)	mm	890x640x1350

OPTIONAL FITTINGS

CODE

10020	V - Frontal wheel for fine sensitive feed
10022	LBC - Digital depth reader
10075	HGP-S - Additional standard spindle, special pitch
10080	HGP - Additional standard spindle, standard pitch
10082	PKB - Base cabinet with door and drawers
10083	PKA - Base cabinet with 2 shelves (only for bench drilling machines without cooling)
10084	PKC - Base cabinet (only for models with intermediate table)
10087	MIF - Fixed intermediate table
10088	MIG - Rotating intermediate table
10085	CC - Cycle counter
10110	SC - Column supplement 200 mm
91118	ERB - Cooling equipment in base

* For machines with intermediate table, the base has no drawer. (ref. PKC)

THREAD METRIC	PITCH*	PITCH WITHWORTH
M.2 / M.2.5	0.45	12H"
M.3	0.5	14H"
M.4	0.7	16H"
M.5	0.8	18H"
M.6 / M.7	1	20H"
M.8 / M.9	1.25	24H"
M.10 / M.11	1.5	
M.14 / M.16	2	
M.18 / M.20 / 22	2.5	

* Right-hand thread pitches
NOTE: Special pitches: All left-hand thread pitches and right-hand thread pitches not included in this table.

ACCESSORIES



TOOL HOLDER



VICES



PEDAL



BIMANUAL COMMAND



DIMENSIONS

TOOL HOLDER

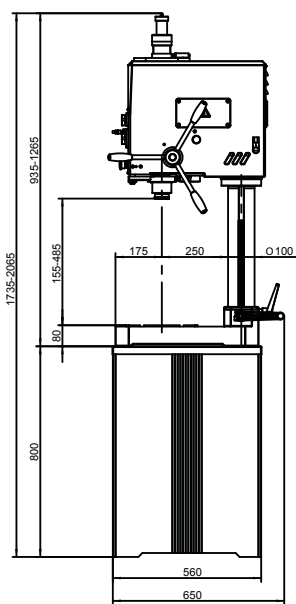

SH-18/30

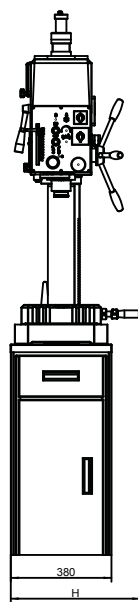

SH18/30 MI

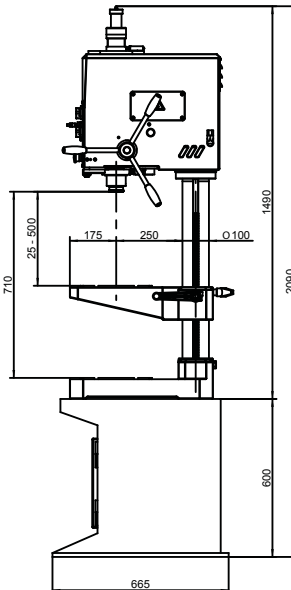

STANDARD TABLE

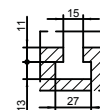
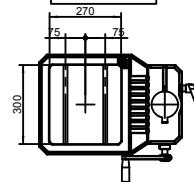

MG

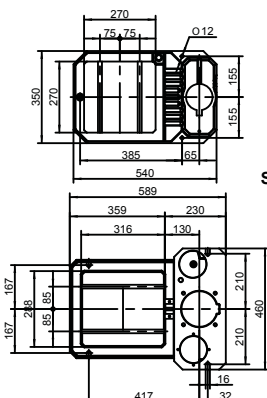
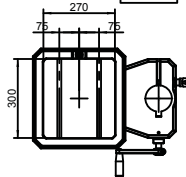

**SERIE S
STANDARD BASE**

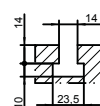
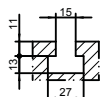

**SERIE SR
BASE CON REFRIGERACIÓN
BASE WITH COOLANT SYSTEM**