



IBERDRILL
— Drilling Machines —

General Catalogue

Bench Drilling machines
Column Drilling machines
Drill Batteries
Special Constructions

Your drilling and tapping specialist because of:

TRADITION

The grey of steel and the green of our valleys. Tenacity, hard work and ambition. From the Basque Country, the heart of the Spanish machine -tool industry, with over 50 years devoted to precision engineering and the manufacturing of drills, IBERDRILL has a level of "know-how" which is widely recognised within the sector.

INTERNATIONALISATION

Open to the world. The competitiveness of our products and our international recognition explain why three in every four of our machines are for export. Their destinies are industrially developed countries such as Germany, France, Switzerland, Italy, Belgium, Usa, Canada, Denmark, etc., with machines installed in the five continents and in the world's leading industries.

LEADERSHIP

The fact that we are the preference and reference in many national and international industries and tenders is the outcome of having fully satisfied the expectations and demands of the users of our machines.

RESEARCH AND DEVELOPMENT

Reflected in the constant capacity for innovation and adaptaion in our product range to the uses and needs of the market.

TECHNOLOGY

Evolution with time and a total command of the latest technology. That's within the ERLO group, we have our own division for the manufacturing of the latest generation of high-performance vertical machining centres.

DESIGN

Thinking of the person at all times, in terms of the efficiency, safety and comfort of the operator. We see design as a strategic competitive tool and apply creative engineering and the most modern computer design techniques in the service of rationalisation, ergonomics and ease of use.

QUALITY

As objective and means. The axis of all our activity, the basis for our prestige and leadership in the market.

PROGRAMME

Round and brilliant as the columns. Solid and robust as their structure. Ample, sufficient and adjusted to every need ... and budget. No confusion, no wasting of your valuable time. We, the specialists, have already done a great deal of your thinking for you.



EK SERIES

Round column drilling machines, belt transmission

Maximum drilling capacity in ST-60: Ø18/25 mm

Optional equipment for EK Series

8-9



T SERIES

Round column drilling machines, geared head

Maximum drilling capacity in ST-60: Ø 25 mm

Optional equipment for T Series

10-11



Z SERIES

Round column drilling machines, belt transmission

Maximum drilling capacity in ST-60: Ø32/34/40 mm

Optional equipment for Z Series

12-15



X SERIES

Round column drilling machines, geared head

Maximum drilling capacity in ST-60: Ø32/34/40 mm

Optional equipment for X Series

16-19



A SERIES

Round column drilling machines, geared head

Maximum drilling capacity in ST-60: Ø40/50 mm

Optional equipment for A Series

20-21



B SERIES

Round column drilling machines, geared head

Maximum drilling capacity in ST-60: Ø40/50/60/70 mm

Optional equipment for B Series

22-23



P SERIES

Box column drilling machines, geared head

Maximum drilling capacity in ST-60: Ø50/70 mm

Optional equipment for P Series

24-25



F SERIES

Box column drilling-milling machines, geared head

26-27

Maximum drilling capacity in ST-60: Ø35 mm

Maximum milling capacity in ST-60: 17 cm³/min

*Optional equipment for **F Series***



C SERIES

Round column drilling machines, combined transmission belt/gear

28-29

Maximum drilling capacity in ST-60: Ø40/50 mm

*Optional equipment for **C Series***



General extra equipment Accessories

30-35



PROFESSIONAL SERIES

Round column drilling machines: Geared head - Belt transmission

36-45

Maximum drilling capacity in ST-60: Ø32/35/40/50 mm

*Optional equipment for **PROFESSIONAL Series***



GANG DRILLING MACHINES

EK/T/Z/X/A/B/P Series

46-49



SPECIAL CONSTRUCTIONS

50-51

DIMENSIONS

Round column drills, prismatic column drills

52-59

** This catalogue is for advertising purposes only. Despite the greatest care in compiling the catalogue, we reserve the right to make spelling mistakes and changes. In the interests of progressive development and optimization of the product portfolio, deviations from technical data, standard equipment, special equipment and design may occur. Some of the images contain special equipment and are therefore similar to the product. If required, please let us make you a current specific offer.

To save time and understand our programme quickly. While the number expresses the direct drilling capacity in steel, the letters stand for:

EK

Belt transmission

- **S:** "small", or bench version
- **M:** "medium", or bench drill with intermediate worktable
- **L:** "large", or pillar version

T

Geared transmission

- **S:** "small", or bench version
- **A:** automatic feed by mechanical clutch
- **M:** "medium", or bench drill with intermediate worktable
- **L:** "large", or pillar version

Z

Belt transmission

- **S:** manual feed
- **A:** automatic feed by mechanical clutch
- **B:** automatic feed by electromagnetic clutch
- **V:** mechanical speed variator

X

Geared transmission

- **S:** manual feed
- **A:** automatic feed by mechanical clutch
- **B:** automatic feed by electromagnetic clutch

A

Geared transmission with automatic feed by mechanical clutch

B

Geared transmission with automatic feed by electromagnetic clutch

C

Mixed transmission belt/geared

- **B:** automatic feed by electromagnetic clutch
- **V:** mechanical speed variator
- **VE:** electronic speed variator

P

Geared transmission (prismatic column drills)

- **B:** automatic feed by electromagnetic clutch

F

Geared transmission (prismatic column drilling/milling machines)

- **B:** automatic feed by electromagnetic clutch

IBERDRILL QUALITY

Not only phrases ...

Traditionally our machines stand for the known robustness and long-life cycle. We always place special value of the massive design of drill housing and pillar to prevent disturbing vibrations and noise developments. The constructive safety factors are consciously generously applied so that the machines can withstand material fatigue very well even after 20 years.

HIGHER MACHINE WEIGHT

More mass for class! Therefore, IBERDRILL machines show a higher total weight in the supplier's comparison.

THE IBERDRILL HOUSING

Thick walls and **large casting radii** are features of all IBERDRILL machines. The used quality casting material has higher strengths and stands for dense and particularly dampening properties. Even in industrial continuous operation, this ensures a homogeneous heat balance of the machines.

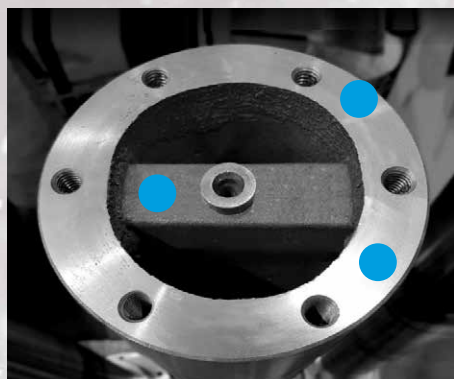
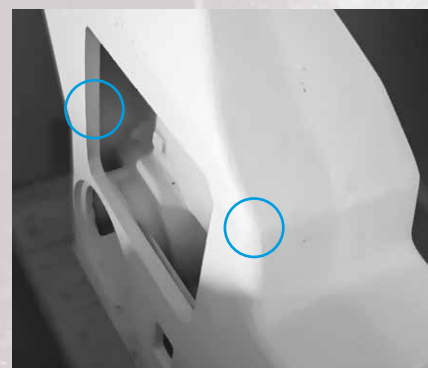

THE IBERDRILL PILLAR

Larger outer diameter, larger wall thickness and an **inner continuous solid center bar** are features of all series. Pillar and bracket flange are always just one piece. This design, coupled with the use of quality material, ensures a torsion-free right-angled head construction, prevents bending and dampens all vibrations during the drilling process to the highest degree.

THE DRIVES

Long service lives and great smoothness are maxims of the design. Thus the axial and radial bearing combinations are made larger.

V-belt drives are equipped with stepped discs of higher balance quality and with quality V-belts as original equipment.

Gear drives include **gear wheels of in-house production**. Strict quality attention is paid to optimized involute toothing, which minimizes wear due to an overhang of the rolling friction, and to wider gear wheels, in order to minimize surface pressure of the same purpose.

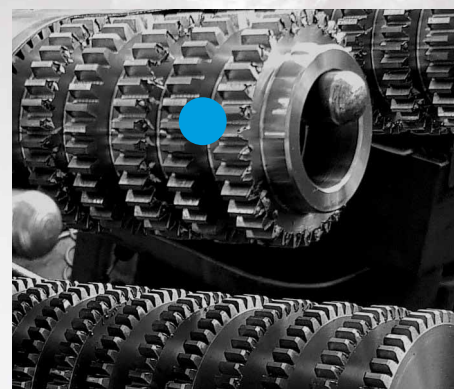

IBERDRILL-we build modern machines with the good quality like "in former times". An investment for a long time.

EK SERIES

your choice for:

Multi-purpose use

Unequalled robustness

Complete equipment

Speed range

Easy to run

Low maintenance

Attractive design

Value for money



EKS-25

ø 18 mm ø 25 mm	M 14 M 18	0,51/1,05 Kw 0,71/1,35 Kw	MT 3 MT 3	120 mm 120 mm	ø 100 mm ø 100 mm	250 mm 250 mm



EKL-25
Standard column
drilling machine



EKS-18
With hidrobloc



EKS-18
With lead screw system

|| STANDARD EQUIPMENT

- Depth scale and adjustable depth stop
- Worklight
- Automatic tool ejector
- Security microswitch on cover
- Thermo-magnetic motor breaker switch
- Emergency STOP push button
- Right-left turn
- Low voltage electric equipment
- Safety drill guard with microswitch
- CE mark

|| OPTIONAL EQUIPMENT

- PKA** Floor cabinet with 2 shelves (only for EKS and EKM models)
- PKB** Floor cabinet with door and drawer (only for EKS and EKM models)
- RS** Automatic feed reversing system for tapping
- VE** Variable speed by electronic variator
- VE + TAK** Continuous speed by electronic variator with automatic turn reversing system for tapping and digital rpm counter
- LBC** Depth scale digital read-out system
- RPF** Pitch controlled tapping with braking system by speed inverter
- HGP** Master guide spindle and nut set

- HGP-S** Special master guide spindle and nut set
- ERB** Coolant system in base
- V** Hand wheel for fine feed work
- MB** Security bimanual command
- HB** Hidrobloc automatic feed system
- MG** Rotating table (only for EKM y EKL models)

EK SERIES

Bench and Column drilling machines

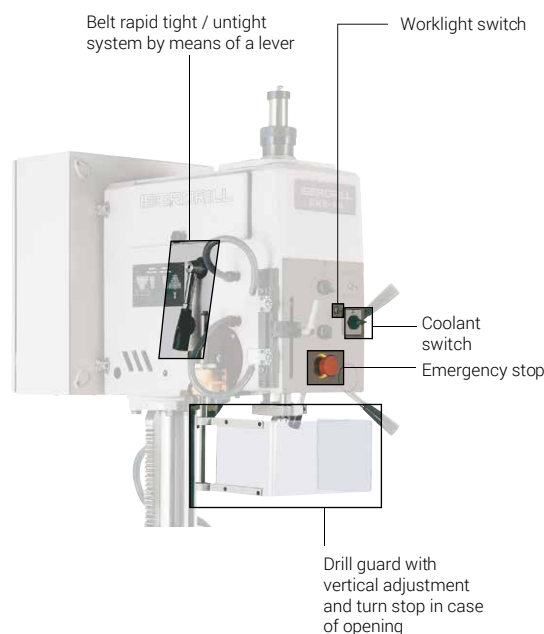
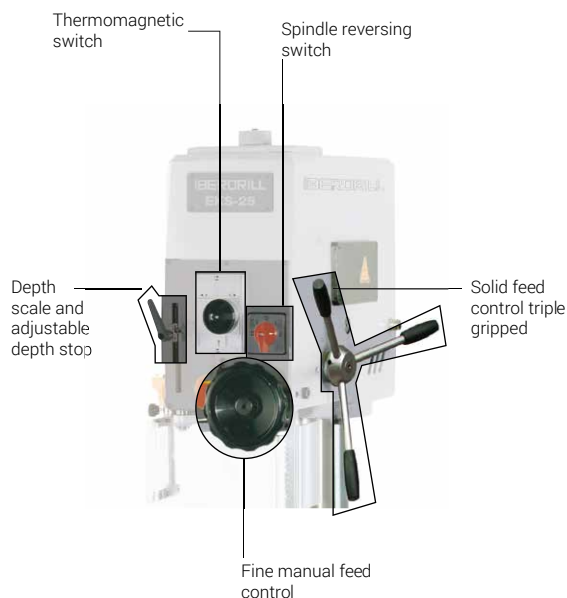

|| CHARACTERISTICS

EKS-18 EKM-18 EKS-25 EKM-25 EKS-30 EKM-30 EKL-18 EKL-25 EKL-30

Maximum drilling capacity in steel St. 50/60	[ø mm]	18		25		30	
Maximum tapping capacity in steel St. 50/60	[mm]	M14		M18		M25	
Morse Taper MT	[Nr.]			3			
Maximum spindle stroke (drilling depth)	[mm]			120			
Main motor power	[HP (Kw)]	0,68 - 1,4 (0,51 - 1,05)		0,95 - 1,8 (0,71 - 1,35)		1,2-2 (0,9-1,5)	
Transmission				Belt			
Number of speeds				10			
Speed range with motor at 750/1500 rpm 50 Hz 3Ph. Upon request: Motor at 900/1800 rpm 60 Hz 3Ph.	[rpm]	245-355-490-710-835-1240-1670-2000-2480-4000 295-425-590-850-1000-1490-2000-2400-2980-4800					
Feed	[mm]	Manual					
Worktable dimensions (LxW)	[mm]	270 x 270 (EKS/EKM 18)		270 x 270 (EKS/EKM 25)		270 x 270 (EKS/EKM 30)	
		270 x 300 (EKL 18)		270 x 300 (EKL 25)		270 x 300 (EKL 30)	
Column diameter	[mm]	100					
Distance from spindle centre to column face	[mm]	250					
Net weight	[Kg]	190	230	190	230	190	230
		250 (EKL 18)		250 (EKL 25)		250 (EKL 30)	
Gross weight with packing	[Kg]	200	250	315	200	250	325
		315 (EKL 18)		325 (EKL 25)		325 (EKL 30)	
Packing dimensions (length x width x height)	[m]	0,7x0,57x1,36	0,7x0,571,84	0,7x0,57x1,36	0,7x0,571,84	0,7x0,57x1,36	0,7x0,571,84
		2,10x0,57x0,8		2,10x0,57x0,8		2,10x0,57x0,8	

T SERIES

your choice for:

State of the art technology

Geared machine head

Complete equipment

Speed range

Easy to run



TM-25



With rotating table (MG).



With floor cabinet with 2 shelves (PKA).



With floor cabinet with door and drawer (PKB).

|| STANDARD EQUIPMENT

- Depth scale and adjustable depth stop
- Worklight
- Automatic tool ejector
- Thermo-magnetic motor breaker switch
- Emergency STOP push button
- Right-left turn
- Low voltage electric equipment
- Safety drill guard with microswitch
- CE mark

|| OPTIONAL EQUIPMENT

- PKA** Floor cabinet with 2 shelves (only for TS and TM models)
- PKB** Floor cabinet with door and drawer (only for TS and TM models)
- RS** Automatic feed reversing system for tapping
- VE** Variable speed by electronic variator
- VE + TAK** Continuous speed by electronic variator with automatic turn reversing system for tapping and digital rpm counter
- LBC** Depth scale digital read-out system
- RPF** Pitch controlled tapping with braking system by speed inverter
- HGP** Master guide spindle and nut set

- HGP-S** Special master guide spindle and nut set
- ERB** Coolant system in base
- V** Hand wheel for fine feed work
- MB** Security bimanual command
- HB** Hidrobloc automatic feed system
- MG** Rotating table (only for TM and TL models)

T SERIES

Bench and column drilling machines

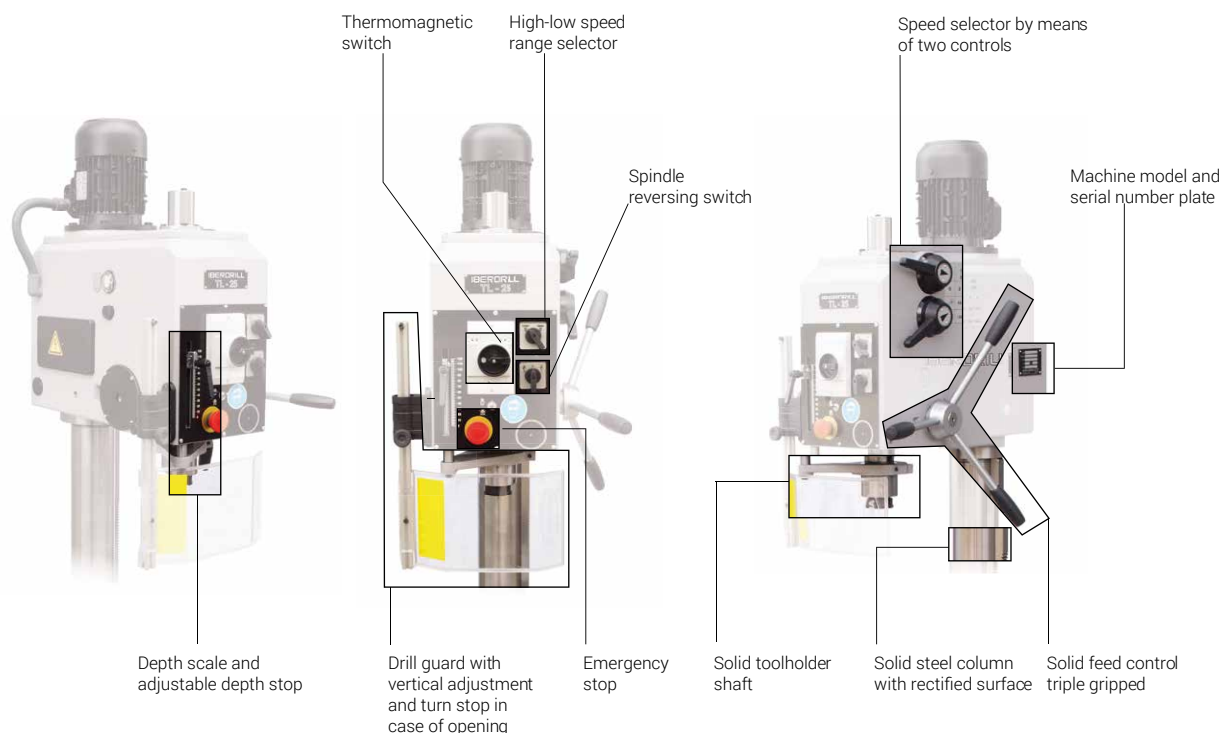

|| CHARACTERISTICS

TS-25
TM-25
TL-25

TSA-25
TMA-25
TLA-25

TS-30
TM-30
TL-30

TSA-30
TMA-30
TLA-30

Maximum drilling capacity in steel St. 50/60	[ø mm]	25		30	
Maximum tapping capacity in steel St. 50/60	[mm]	M 18		M 25	
Morse Taper MT	[Nr.]	3			
Maximum spindle stroke (drilling depth)	[mm]	120			
Main motor power	[HP (Kw)]	1,1/1,6 (0,82/1,2)		1,5/1,9 (1,13-1.43)	
Transmission		Gera box			
Number of speeds		8			
Speed range with motor at 1500/3000 rpm 50 Hz 3Ph. Upon request: Motor at 1800/3600 rpm 60 Hz 3Ph.	[mm]	65-125-185-365-540-1055-1560-3060 78-150-222-438-648-1266-1872-3672			
Feed		Manual	Automatic	Manual	Automatic
Nr. of automatic feeds		-	2	-	2
Automatic feed range	[mm/rev]	-	0,1-0,2	-	0,1-0,2
Worktable dimensions (LxW).	[mm]	270x270 (TS-25) 300x270 (TM/TL-25)	270x270 (TSA-25) 300x270 (TMA/TLA-25)	270x270 (TS-30) 300x270 (TM/TL-30)	270x270 (TSA-30) 300x270 (TMA/TLA-30)
Column diameter	[mm]	100			
Distance from spindle centre to column face	[mm]	250			
Net weight	[Kg]	200 (TS-25) 240 (TM-25) 250 (TL-25)	200 (TSA-25) 240 (TMA-25) 250 (TLA-25)	200 (TS-30) 240 (TM-30) 250 (TL-30)	200 (TSA-30) 240 (TMA-30) 250 (TLA-30)
Gross weight with packing	[Kg]	210 (TS-25) 260 (TM-25) 310 (TL-25)	210 (TSA-25) 260 (TMA-25) 310 (TLA-25)	210 (TS-30) 260 (TM-30) 310 (TL-30)	210 (TSA-30) 260 (TMA-30) 310 (TLA-30)
Packing dimensions (length x width x height)	[m]	0,8x0,6x1,45 (TS-25) 0,8x0,57x1,93 (TM-25) 2,2x0,6x0,9 (TL-25)	0,8x0,6x1,45 (TSA-25) 0,8x0,57x1,93 (TMA-25) 2,2x0,6x0,9 (TLA-25)	0,8x0,6x1,45 (TS-30) 0,8x0,57x1,93 (TM-30) 2,2x0,6x0,9 (TL-30)	0,8x0,6x1,45 (TSA-30) 0,8x0,57x1,93 (TMA-30) 2,2x0,6x0,9 (TLA-30)

Z SERIES

your decision for:



The silence of their belts

Speed variator

Suitable size and capacity

Easy to run

Low maintenance

Attractive price



ø 32 mm



M 22



0,9/1,3 Kw



MT 3



150 mm



ø 125 mm



300 mm



With rotating table plate and tilting support (MGI).



With reversible tiltable with vice (MGM).

|| STANDARD EQUIPMENT

- Depth scale and adjustable depth stop
- Automatic tool ejector
- Thermomagnetic switch
- Emergency STOP push button
- Spindle reversing switch
- Slow / fast speed selector
- Machined base with coolant tank
- Worklight
- Safety drill guard with microswitch
- CE mark

|| OPTIONAL EQUIPMENT

- MGI** Rotating table and tilting support
- MGM** Reversible tiltable with vice
- RS** Automatic feed reversing system for tapping
- HB** Hidrobloc automatic feed system
- TAK** Digital rpm counter (only for V models)
- VE** Variable speed by electronic variator

- RS+VE** Automatic feed reversing system for tapping and Variable speed by electronic variator
- SC** Column riser (200mm)
- LBC** Depth scale digital read-out system

Z SERIES

Round Column - Belt transmission

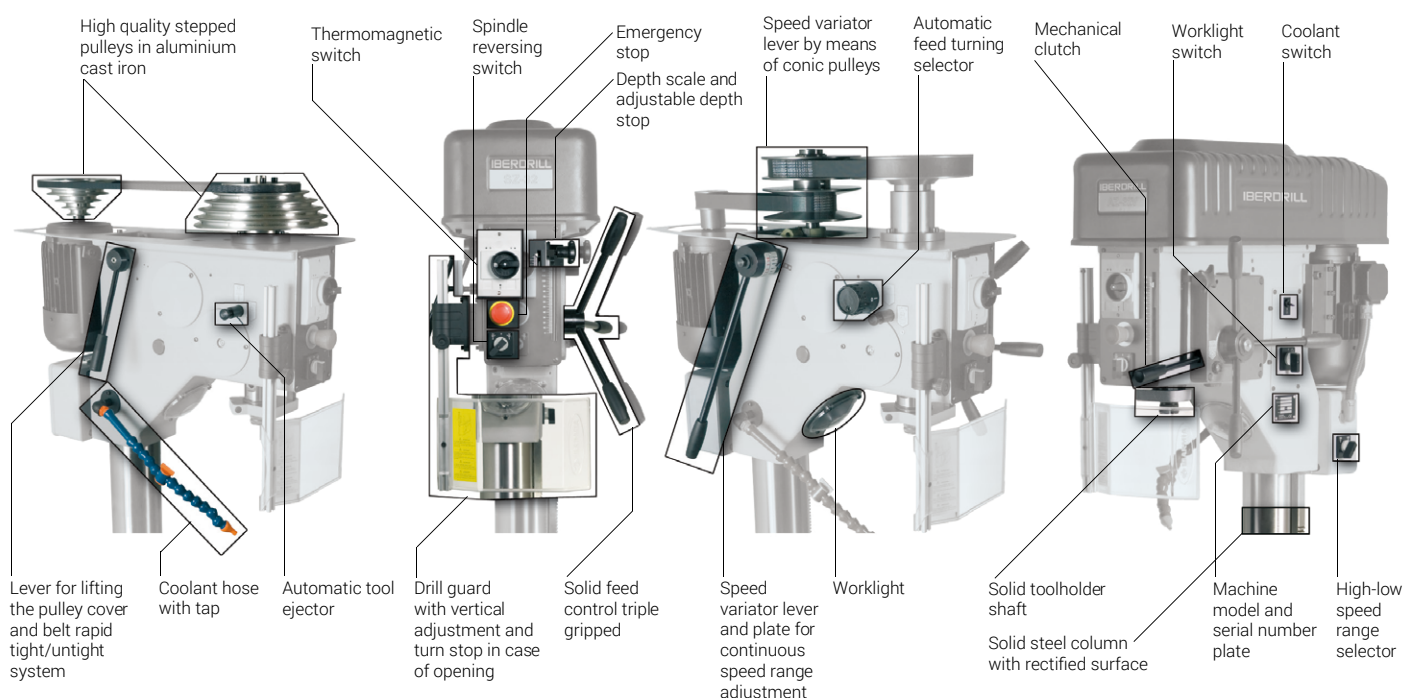

|| CHARACTERISTICS

SZ-32

AZ-32V

Maximum drilling capacity in steel St. 50/60	[ø mm]	32	
Maximum drilling capacity in cast iron 200 Brinell	[ø mm]	35	
Maximum tapping capacity in steel St. 50/60	[mm]	M 22	
Maximum tapping capacity in cast iron 200 Brinell	[mm]	M 30	
Morse Taper MT	[Nr.]	3	
Maximum spindle stroke (drilling depth)	[mm]	150	
Main motor power	[HP (Kw)]	1,20 / 1,80 (0,9 / 1,3)	
Coolant pump motor power	[HP (Kw)]	0,10 (0,07)	
Transmission		Belt drive	Belt drive
Number of speeds		10	Continuous
Speed range with motor at 750/1500 rpm 50 Hz Tri. Upon request: Motor at 900/1800 rpm 60 Hz Tri.	[rpm]	145-220-290-345 440-540-690-860- 1080-1720	80-1170
Feed		Manual	Automatic
Nr. of automatic feeds		-	2
Automatic feed range	[mm/rev]	-	0,1-0,2
Worktable dimensions (LxW).	[mm]	400x420	
Column diameter	[mm]	125	
Distance from spindle centre to column face	[mm]	300	
Net weight	[Kg]	260	290
Gross weight with packing	[Kg]	310	340
Packing dimensions (length x width x height)	[m]	2,3x0,6x1,1	

Z SERIES

your decision for:



Innovative design

Smooth & Silent

Electronic speed variator

Digital rpm counter

Automatic feed reversing for tapping

Easy to run

Low maintenance



ø 34 mm
ø 40 mm



M 27
M 33



3 Kw
4,12 Kw



MT 4
MT 4



150 mm
180 mm



ø 125 mm
ø 150 mm



300 mm
350 mm



With rotating table
plate and tilting
support (MGI).



With reversible tiltable
with vice (MGM).

|| STANDARD EQUIPMENT

- Electronic speed inverter
- Speed setting potentiometer
- Digital rpm counter
- RS Automatic feed reversing system for tapping
- Depth scale and adjustable depth stop
- Automatic tool ejector
- Emergency STOP push button
- Rightwards turn push-button
- Leftwards turn push-button
- Electric equipment integrated on machine's head
- Machined base with coolant tank
- Worklight
- Safety drill guard with microswitch
- Fixed table only for 34 model
- Rotating and tilting table only for 40 model
- CE Mark

|| OPTIONAL EQUIPMENT

- MGI** Rotating table and tilting support (only for 34 models)
- MGM** Reversible tiltable with vice (only for 34 models)
- ACNL** Pneumatic counterbalance with rapid approach and retract (only for BZ models)
- CI** Integral drilling cycle with encoder (only for BZ models)
- HB** Hidroblock automatic feed system
- UC** Union, dragging cone and assembly for multi-spindle head
- GM** Multi-spindle head guide rod
- SC** Column riser (200 mm)
- CN** Pneumatic counterbalance
- LBC** Depth scale digital read-out system
- CM** Auxiliary commanding box (Start-stop & Emergency stop)
- MB** Security bimanual command (only for BZ model)

Z SERIES

Round Column - Belt transmission

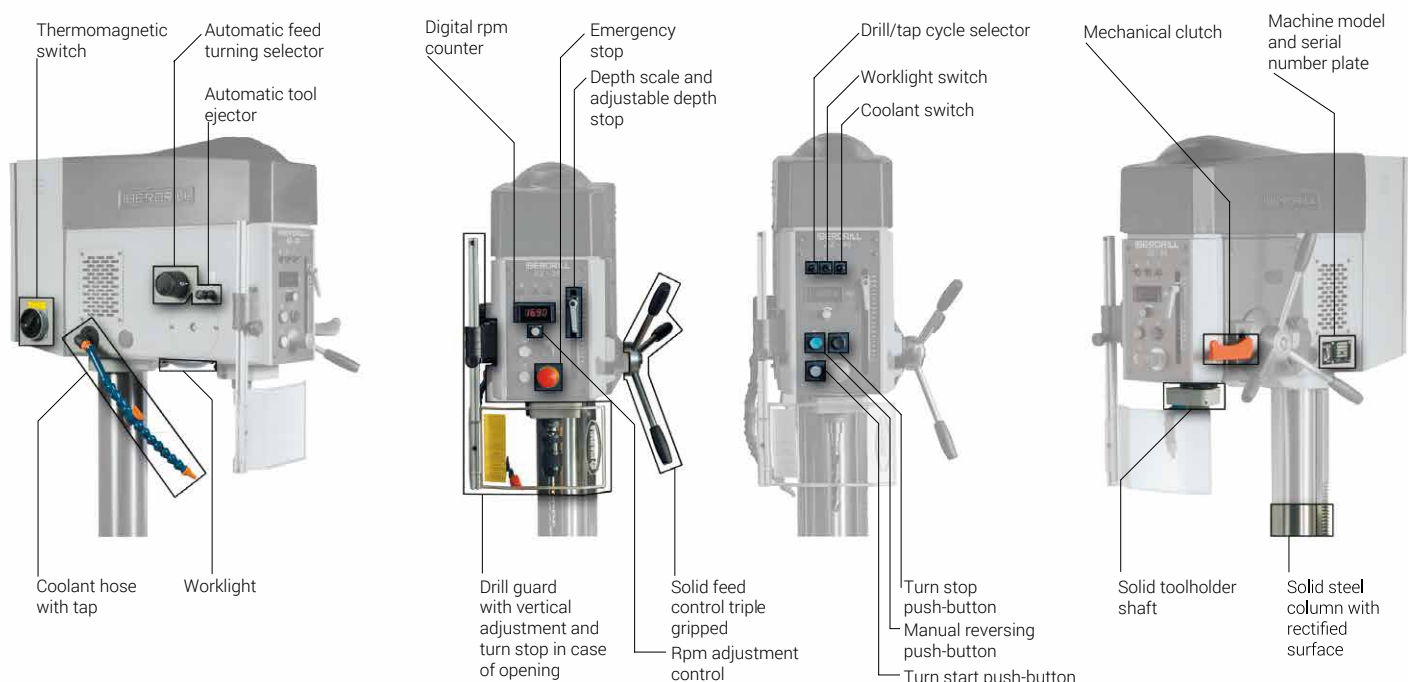

|| CHARACTERISTICS

SZ-34

AZ-34

BZ-34

SZ-40

AZ-40

BZ-40

Maximum drilling capacity in steel St. 50/60	[ø mm]	34			40		
Maximum drilling capacity in cast iron 200 Brinell	[ø mm]	40			45		
Maximum tapping capacity in steel St. 50/60	[mm]	M 27			M 33		
Maximum tapping capacity in cast iron 200 Brinell	[mm]	M 33			M 39		
Morse Taper MT	[Nr.]	4					
Maximum spindle stroke (drilling depth)	[mm]	150			180		
Main motor power	[HP (Kw)]	4 (3)			5,5 (4,12)		
Coolant pump motor power	[HP (Kw)]	0,10 (0,07)					
Transmission		Belt					
Number of speeds		Continuous					
Speed variator type		Electronic					
Speed range with motor at 1500 rpm 50 Hz 3Ph. Upon request: Motor at 1800 rpm 60 Hz 3Ph. (118-2360 rpm)	[rpm]	100-2000					
Feed		Manual	Automatic		Manual	Automatic	
Nr. of automatic feeds		-	3		-	3	
Automatic feed range	[mm/rev]	-	0,1-0,2-0,3		-	0,1-0,2-0,3	
Worktable dimensions (LxW).	[mm]	400x420			480x480		
Column diameter	[mm]	125			150		
Distance from spindle centre to column face	[mm]	300			350		
Net weight	[Kg]	345	360	370	445	460	470
Gross weight with packing	[Kg]	395	410	420	495	510	520
Packing dimensions (length x width x height)	[m]	2,3x0,6x1,1					

X SERIES

your decision for:

Proven success

Optimum mechanical system

Suitable size and capacity

Easy to run

Long life

Optimum value for money



With rotating table plate and tilting support (MGI).



With reversible tiltable with vice (MGM).

|| STANDARD EQUIPMENT

- Hardened and ground high quality steel gears
- Speed plate and selecting levers on head front
- Depth scale and adjustable depth stop
- Thermomagnetic switch
- Emergency STOP push button
- Spindle reversing switch
- Machined base with coolant tank
- Worklight
- Fixed table
- Safety drill guard with microswitch
- CE mark

|| OPTIONAL EQUIPMENT

- VE** Continuous speed by electronic variator
- VE+TAK** Continuous speed by electronic variator digital rpm counter
- MGI** Rotating table and tilting support
- MGM** Reversible tiltable with vice
- RS** Automatic feed reversing system for tapping
- RPF** Pitch controlled tapping with braking system by speed inverter
- RPF+TAK** Pitch controlled tapping with braking system by speed inverter and digital rpm counter
- HGP** Master guide spindle and nut set
- HGP-S** Special master guide spindle and nut set

- HB** Hidroblock automatic feed system
- ACNL** Pneumatic counterbalance with rapid approach and retract (only BX models)
- CI** Integral drilling cycle with encoder (only BX models)
- CI+RPF** Integral drilling cycle with encoder and pitch controlled tapping with braking system by speed inverter
- UC** Union, dragging cone and assembly for multi-spindle head
- GM** Multi-spindle head guide rod
- CN** Pneumatic counterbalance
- SC** Column riser (200 mm)
- CM** Auxiliary commanding box (Start-stop & Emergency stop)
- LBC** Depth scale digital read-out system
- MB** Security bimanual command (only BX models)

X SERIES

Round Column - Gear transmission

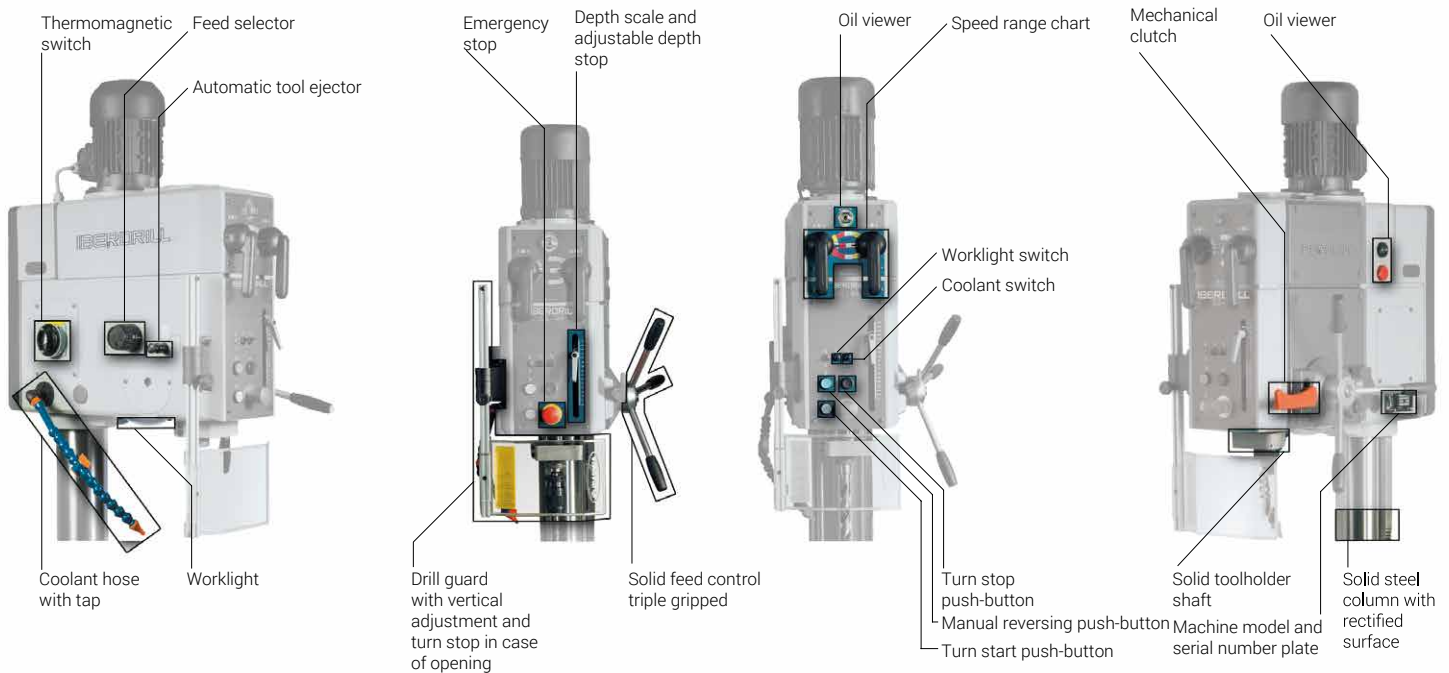

|| CHARACTERISTICS

SX-32

AX-32

BX-32

Maximum drilling capacity in steel St. 50/60	[ø mm]	32		
Maximum drilling capacity in cast iron 200 Brinell	[ø mm]	35		
Maximum tapping capacity in steel St. 50/60	[mm]	M 22		
Maximum tapping capacity in cast iron 200 Brinell	[mm]	M 27		
Morse Taper MT	[Nr.]	4		
Maximum spindle stroke (drilling depth)	[mm]	150		
Main motor power	[HP (Kw)]	1,5 (1,1)		
Coolant pump motor power	[HP (Kw)]	0,10 (0,07)		
Transmission		Gear box		
Number of speeds		9		
Speed range with motor at 1500 rpm 50 Hz 3Ph. Upon request: Motor at 1800 rpm 60 Hz 3Ph. (160-2220 rpm)	[rpm]	132-194-277-319-466-666-883-1296-1852		
Feed		Manual	Automatic	Automatic
Nr. of automatic feeds		-	3	
Automatic feed range	[mm/rev]	-	0,1-0,2-0,3	
Worktable dimensions (LxW).	[mm]	400x420		
Column diameter	[mm]	125		
Distance from spindle centre to column face	[mm]	300		
Net weight	[Kg]	385	400	410
Gross weight with packing	[Kg]	435	450	460
Packing dimensions (length x width x height)	[m]	2,3x0,6x1,1		2,34x0,61x1,16

X SERIES

your decision for:



Innovation design

Variety of alternatives

Suitable size and capacity

Easy to run

Long life

Mechanical reliability



ø 34 mm
ø 40 mm



M 27
M 33



1,5 Kw
2,2 Kw



MT 4
MT 4



150 mm
180 mm



ø 125 mm
ø 150 mm



300 mm
350 mm



With rotating table
plate and tilting
support (MGI).



With reversible tiltable
with vice (MGM).

|| STANDARD EQUIPMENT

- Hardened and ground high quality steel gears
- Speed plate and selecting levers on head front.
- Depth scale and adjustable depth stop
- Automatic tool ejector
- Emergency STOP push button
- Spindle reversing switch
- Electric equipment integrated on machine's head
- Machined base with coolant tank
- Worklight
- MF: Fixed table for model 34
- MGI: Rotating and tilting table for model 40
- Safety drill guard with microswitch
- CE mark

|| OPTIONAL EQUIPMENT

- MGI** Rotating table and tilting support (only for 34 models)
- MGM** Reversible tiltable with vice (only for X-34 model)
- RS** Automatic feed reversing system for tapping
- RPF** Pitch controlled tapping with braking system by speed inverter
- HGP-S** Special master guide spindle and nut set
- ACNL** Pneumatic counterbalance with rapid approach and retract (only for BX models)
- CI** Integral drilling cycle with encoder (only for BX models)
- HB** Hidrobloc automatic feed system
- UC** Union, dragging cone and assembly for multi-spindle head
- GM** Multi-spindle head guide rod
- PM** START/STOP/EMERGENCY control extensión (only for BX models)
- SC** Column riser (200 mm)

X SERIES

Round column - Gear Transmission

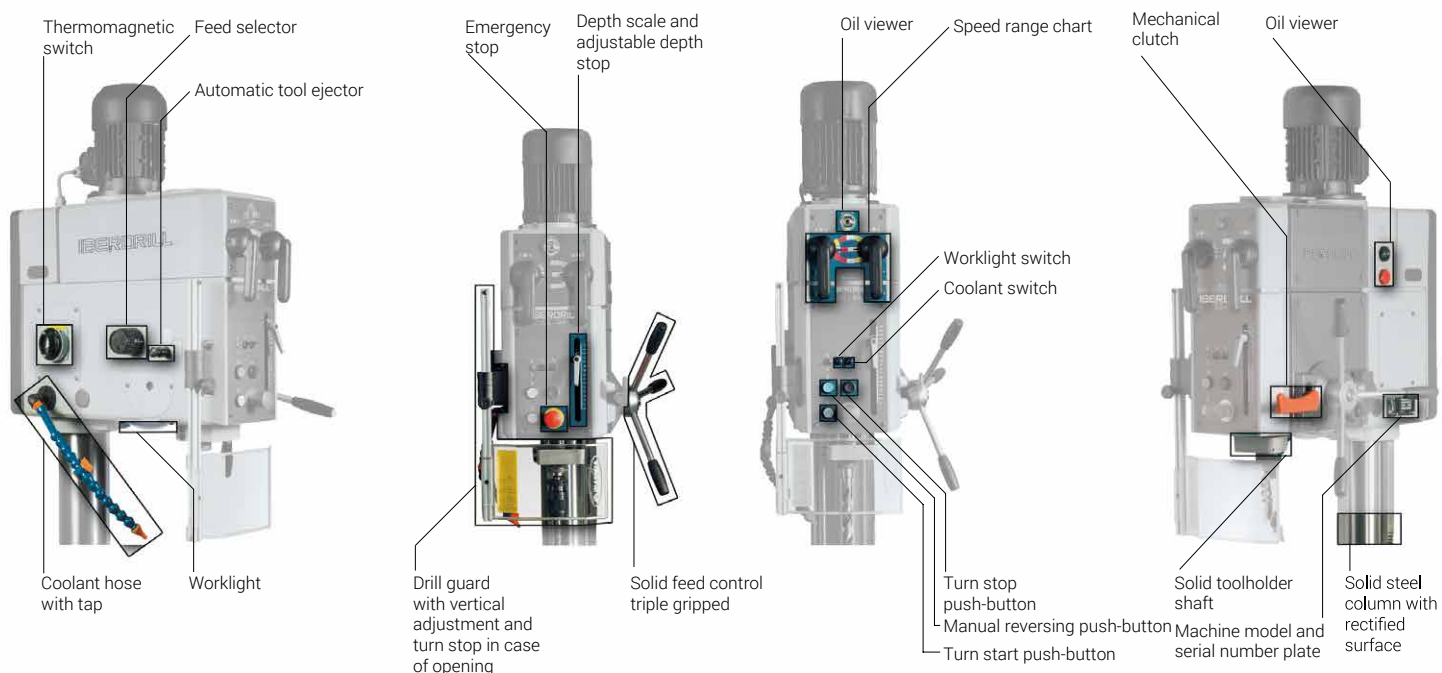

|| CHARACTERISTICS

SX-34 AX-34 BX-34 SX-40 AX-40 BX-40

Maximum drilling capacity in steel St. 50/60	[ø mm]	34			40		
Maximum drilling capacity in cast iron 200 Brinell	[ø mm]	40			45		
Maximum tapping capacity in steel St. 50/60	[mm]	M 27			M 33		
Maximum tapping capacity in cast iron 200 Brinell	[mm]	M 33			M 39		
Morse Taper MT	[Nr.]	4					
Maximum spindle stroke (drilling depth)	[mm]	150			180		
Main motor power	[HP (Kw)]	2 (1,5)			3 (2,2)		
Coolant pump motor power	[HP (Kw)]	0,10 (0,07)					
Transmission		Gear box					
Number of speeds		9					
Speed range with motor at 1500 rpm 50 Hz 3Ph. Upon request: Motor at 1800 rpm 60 Hz 3Ph. (160-2220 rpm)	[rpm]	132-194-277-319-466-666-883-1296-1852					
Feed		Manual	Automatic		Manual	Automatic	
Nr. of automatic feeds		-	3		-	3	
Automatic feed range	[mm/rev]	-	0,1-0,2-0,3		-	0,1-0,2-0,3	
Worktable dimensions (LxW).	[mm]	400x420			480x480		
Column diameter	[mm]	125			150		
Distance from spindle centre to column face	[mm]	300			350		
Net weight	[Kg]	385	400	410	475	490	500
Gross weight with packing	[Kg]	435	450	460	525	540	550
Packing dimensions (length x width x height)	[m]	2,3x0,6x1,1					

A SERIES

your choice for:



Mechanical reliability

Size and ergonomics

Industrial use

Real capacity

Variety of sizes

Full equipment

Long life

Lasting value



ø 40 mm
ø 50 mm



M 33
M 36



2,2 Kw
3 Kw



MT 4
MT 4



200 mm
230 mm



ø 175 mm
ø 200 mm



360 mm
400 mm



With rotating table plate
and tilting support (MGI).

|| STANDARD EQUIPMENT

- Hardened and ground high quality steel gears
- Speed plate and selecting levers on head front
- Gear box lubrication by automatic pump
- Machined base with coolant tank
- Worklight
- Rotating table plate
- Automatic feed and cut-off by mechanical clutch
- Front hand wheel for fine feed work
- MGI Rotating and tilting table
- Depth scale and adjustable depth stop
- Automatic tool ejector
- Electric equipment integrated on machine's head
- Emergency STOP push button
- Spindle reversing switch
- Safety drill guard with microswitch
- CE mark

|| OPTIONAL EQUIPMENT

- RS** Automatic feed reversing system for tapping
- RPF** Pitch controlled tapping with braking system by speed inverter
- RPF+TAK** Pitch controlled tapping with braking system by speed inverter and digital rpm counter
- HGP** Master guide spindle and nut set
- HGP-S** Special master guide spindle and nut set
- AR** 50% lowered feed rate range
- CN** Pneumatic counterbalance
- UC** Union, dragging cone and assembly for multi-spindle
- GM** Multi-spindle head guide rod
- SC** Column riser (200 mm)
- VE** Variable speed by electronic variator
- VE+TAK** Continuous speed by electronic variator with automatic turn reversing system for tapping and digital rpm counter
- LBC** Depth scale digital read-out system

A SERIES

Round column - Gear Transmission

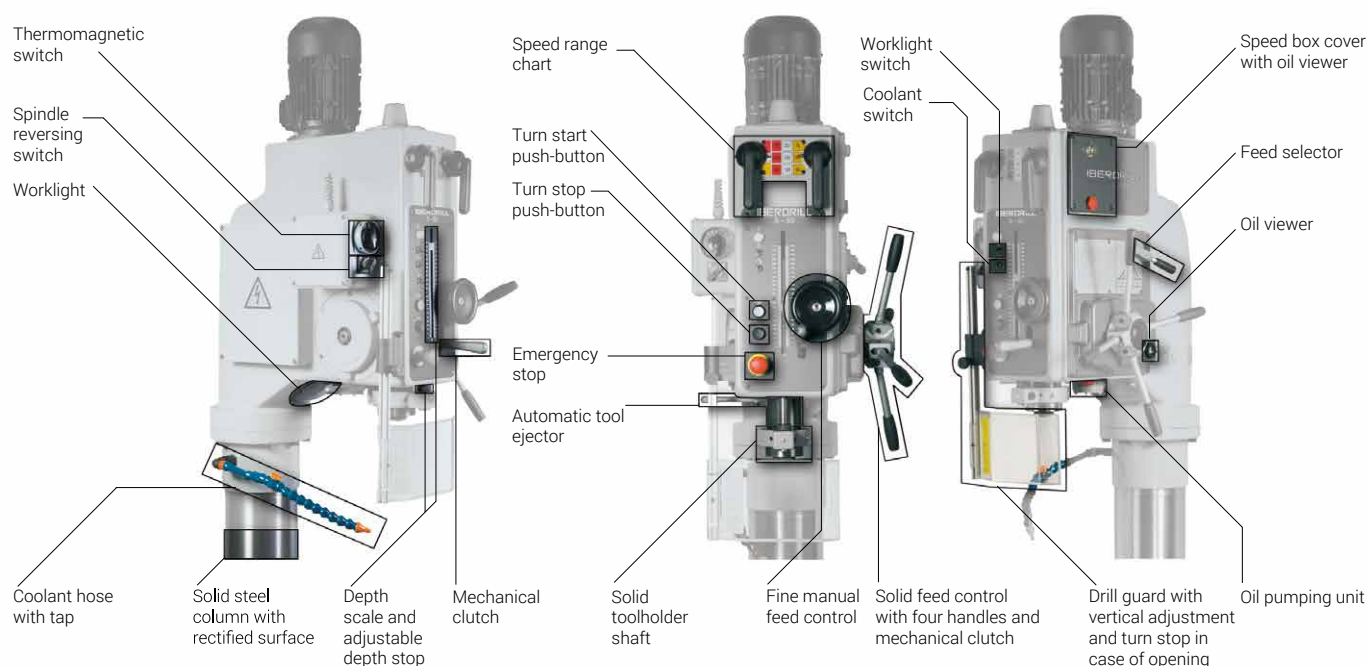

|| CHARACTERISTICS

A-40

A-50

Maximum drilling capacity in steel St. 50/60	[ø mm]	40	50
Maximum drilling capacity in cast iron 200 Brinell	[ø mm]	50	60
Maximum tapping capacity in steel St. 50/60	[mm]	M 33	M 36
Maximum tapping capacity in cast iron 200 Brinell	[mm]	M 40	M 42
Morse Taper MT	[Nr.]	4	
Maximum spindle stroke (drilling depth)	[mm]	200	230
Main motor power	[HP (Kw)]	3 (2,2)	4 (3)
Coolant pump motor power	[HP (Kw)]	0,10 (0,07)	
Transmission		Gear box	
Number of speeds		9	
Speed range with motor at 1500 rpm 50 Hz 3Ph. Upon request: Motor at 1800 rpm 60 Hz 3Ph.	[rpm]	61-85-123 191-269-390 574-806-1169	54-75-109 169-237-344 507-712-1032
Feed		Automatic by mechanical clutch	
Nr. of automatic feeds		4	
Automatic feed range	[mm/rev]	0,1-0,2-0,3-0,4	
Worktable dimensions (LxW).	[mm]	550X550	
Column diameter	[mm]	175	200
Distance from spindle centre to column face	[mm]	360	400
Net weight	[Kg]	610	710
Gross weight with packing	[Kg]	695	795
Packing dimensions (length x width x height)	[m]	2,5x0,6x1,2	2,6x0,6x1,2

B SERIES

your choice for:



With rotating table plate
and tilting support (MGI)

Easy to run

Mechanical reliability

Technology

Size and ergonomics

Industrial use

True capacity

Variety of sizes

Full equipment

Long life

Lasting value

ø 40 mm ø 50 mm ø 60 mm ø 70 mm	M 33 M 36 M 42 M 50	2,2 Kw 3 Kw 4 Kw 5,5 Kw	MT 4 MT 4 MT 5 MT 5	200 mm 230 mm 260 mm 260 mm	ø 175 mm ø 200 mm ø 220 mm ø 220 mm	360 mm 400 mm 420 mm 420 mm

|| STANDARD EQUIPMENT

- Hardened and group high quality steel gears
- Speed plate and selecting levers on head
- Gear box lubrication by automatic pumps
- Machine base with coolant tank and pump
- Worklight
- MGI Rotating and tilting table
- Automatic feed and cut-off by electromagnetic clutch
- Front hand wheel for fine feed work
- Depth scale and adjustable depth stop
- Automatic tool ejector
- Electric equipment integrated on machine's head
- Emergency STOP push button
- Spindle reversing switch
- Safety drill guard with microswitch
- CE mark

|| OPTIONAL EQUIPMENT

- RS** Automatic feed reversing system for tapping
- RPF** Pitch controlled tapping with braking system by speed inverter
- RPF+TAK** Pitch controlled tapping with braking system by speed inverter and digital rpm counter
- HGP** Master guide spindle and nut set
- HGP-S** Special master guide spindle and nut set
- ACNL** Pneumatic counterbalance with rapid approach and retract
- CI** Integral drilling cycle with encoder
- CI+RPF** Integral drilling cycle with encoder and pitch controlled tapping with braking system by speed inverter
- AR** 50% lowered feed rate range
- CN** Pneumatic counterbalance
- UC** Union, dragging cone and assembly for multi-spindle head
- GM** Multi-spindle head guide rod
- PM** START/STOP/EMERGENCY control extensión
- SC** Column riser (200 mm)
- VE** Variable speed by electronic variator
- VE+TAK** Continuous speed by electronic variator with automatic turn reversing system for tapping and digital rpm counter
- LBC** Depth scale digital read-out system
- MB** Security bimanual command

B SERIES

Round column - Gear transmission

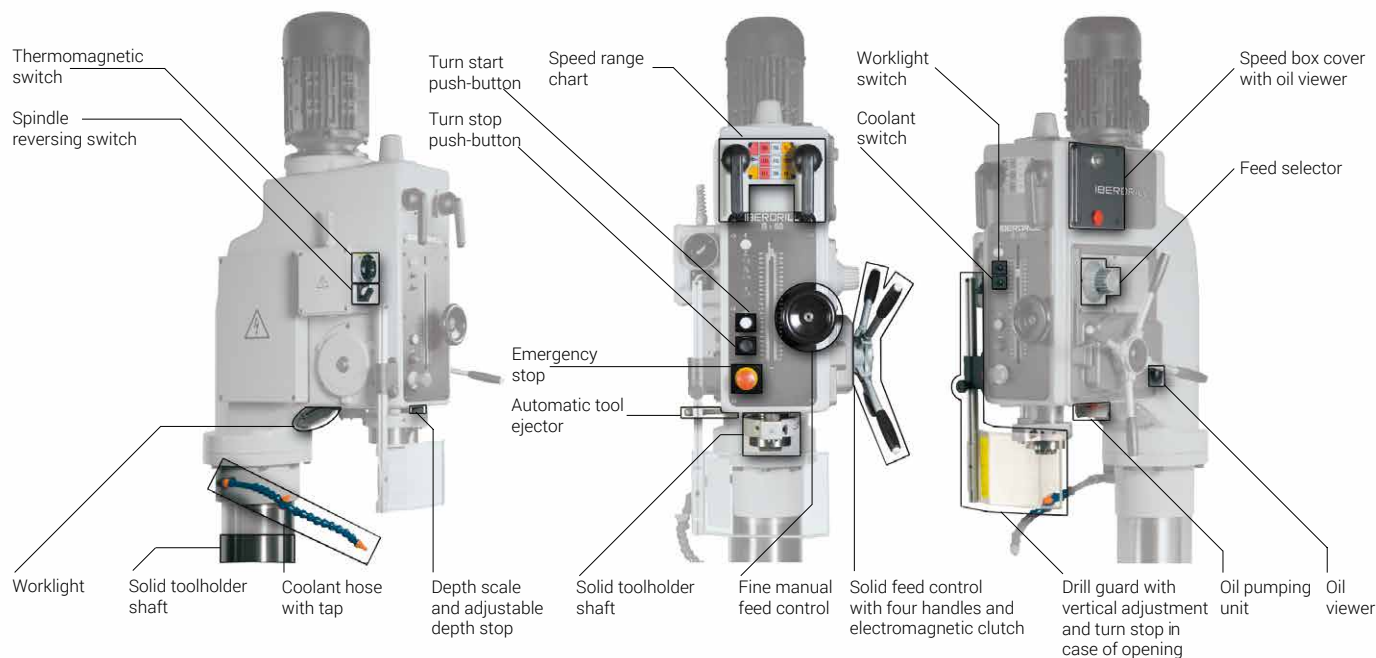

|| CHARACTERISTICS

B-40

B-50

B-60

B-70

Maximum drilling capacity in steel St. 50/60	[ø mm]	40	50	60	70
Maximum drilling capacity in cast iron 200 Brinell	[ø mm]	50	60	70	80
Maximum tapping capacity in steel St. 50/60	[mm]	M 33	M 36	M 42	M 50
Maximum tapping capacity in cast iron 200 Brinell	[mm]	M 40	M 42	M 50	M 60
Morse Taper MT	[Nr.]	4		5	
Maximum spindle stroke (drilling depth)	[mm]	200	230	260	260
Main motor power	[HP (Kw)]	3 (2,2)	4 (3)	5,5 (4)	7,5 (5,5)
Coolant pump motor power	[HP (Kw)]	0,10 (0,07)		0,12 (0,09)	
Transmission		Gear box			
Number of speeds		9		12	
Speed range with motor at 1500 rpm 50 Hz 3Ph. Upon request: Motor at 1800 rpm 60 Hz 3Ph.	[rpm]	61-85-123 191-269-390 574-806-1169	54-75-109 169-237-344 507-712-1032	64-80-106-138 199-248-328-429 561-701-926-1210	51-64-84-110 158-198-262-342 447-559-738-966
Feed		Automatic by electromagnetic clutch			
Nr. of automatic feeds		4	6		
Automatic feed range	[mm/rev]	0,1-0,2-0,3-0,4	0,1-0,2-0,3-0,4-0,5-0,6		
Worktable dimensions (LxW).	[mm]	550x550		600x600	
Column diameter	[mm]	175	200	220	
Distance from spindle centre to column face	[mm]	360	400	420	
Net weight	[Kg]	610	720	820	840
Gross weight with packing	[Kg]	695	805	920	940
Packing dimensions (length x width x height)	[m]	2,5x0,6x1,2	2,6x0,6x1,2	2,7x0,7x1,2	

P SERIES

your purchase for:



Power

Precision

Productivity

Mechanical reliability

Technology

industrial use

True capacity

Variety of sizes

Complete equipment

Long life

Lasting value

ø 50 mm ø 70 mm	M 45 M 70	4 Kw 7,3 Kw	MT 4 MT 5	240 mm 300 mm	460 mm 630 mm

|| STANDARD EQUIPMENT

- Adjusting of the vertical position of motorreductor the head by geared-motor.
- Hardened and ground high quality steel gears
- Gear box lubrication by automatic pump
- Automatic guide greasing by manual pump
- Coolant tank and pump in machine base
- Worklight
- Fixed worktable
- Automatic feed and cut-off by electromagnetic clutch
- Front hand wheel for fine feed work
- Depth scale and adjustable depth stop.
- Automatic tool ejector
- Electric equipment integrated on machine's head.
- Rightwards turn push button
- Leftwards turn push button
- Safety drill guard with microswitch
- CE mark

|| OPTIONAL EQUIPMENT

- RPF** Pitch controlled tapping with braking system by speed inverter
- HGP** Master guide spindle and nut set
- HGP-S** Special master guide spindle and nut set
- ACNL** Pneumatic counterbalance with rapid approach and retract
- ACNL-2** Pneumatic counterbalance with rapid approach and retract (2 cylinder)
- CI** Integral drilling cycle with encoder
- CI+RPF** Integral drilling cycle with encoder and pitch controlled tapping with braking system by speed inverter
- CN** Pneumatic counterbalance
- UC** Union, dragging cone and assembly for multi-spindle head
- GM** Multi-spindle head guide rod
- GM2** Multi-spindle head guide rod (with 2 axis)
- PM** START/STOP/EMERGENCY control extensión
- RFCM** Coolant hose for multispindle head
- ISO-40** ISO-40 spindle (only 50 models)
- ISO-50** ISO-50 spindle (only 70 models)

P SERIES

Prismatic column - Gear transmission

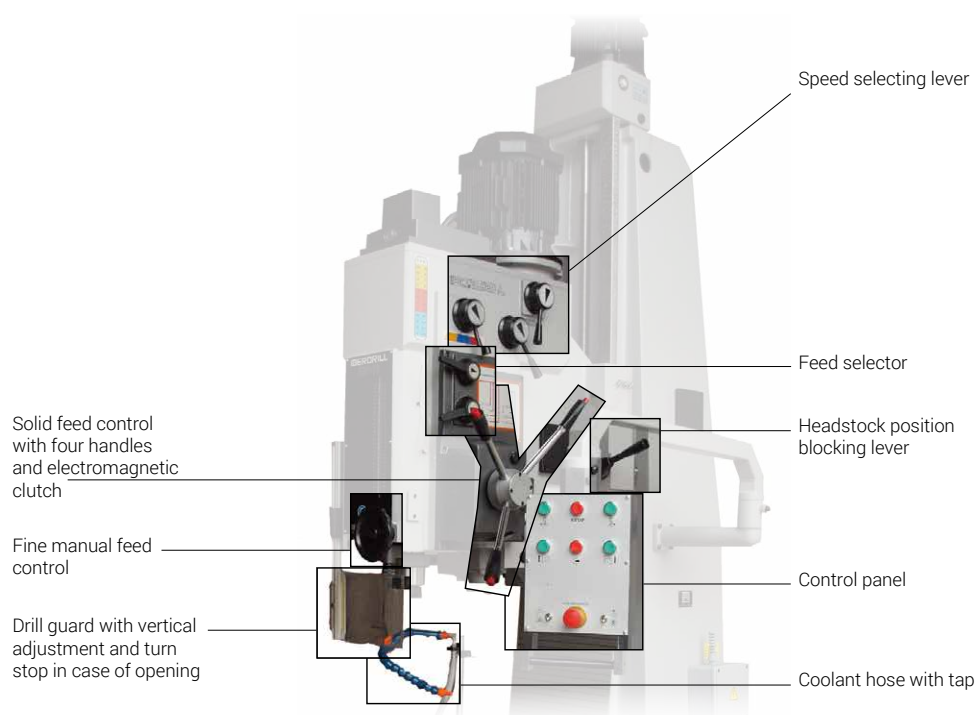

|| CHARACTERISTICS

EBP-50

EBP-70

Maximum drilling capacity in steel St. 50/60	[ø mm]	50	70
Maximum tapping capacity in steel St. 50/60	[mm]	M 45	M 70
Morse Taper MT	[Nr.]	4	5
ISO taper (upon request)	[Nr.]	40	50
Maximum spindle stroke (drilling depth)	[mm]	240	300
Main motor power	[HP (Kw)]	5,5 (4)	10 (7,3)
Coolant pump motor power	[HP (Kw)]	0,12 (0,09)	
Rise and falling head geared-motor power	[HP (Kw)]	1,5 (1,1)	
Transmission		Gear box	
Number of speeds		9	12
Speed range with motor at 1500 rpm 50 Hz 3Ph. Upon request: Motor at 1800 rpm 60 Hz 3Ph.	[rpm]	68-100-150-200-295 -440-565-855-1270 82-120-180-240-354- 528-678-1026-1524	35-49-72-97-128-173-254 -343-461-624-915-1238 42-59-86-116-154-208-305- 412-553-749-1098-1486
Feed		Automatic by electromagnetic clutch	
Nr. of automatic feeds		4	6
Automatic feed range	[mm/rev]	0,1-0,2-0,3-0,4	0,05-0,10-0,15-0,20-0,35-0,50
Worktable dimensions (LxW).	[mm]	800x600	1040x600
Distance from spindle centre to column face	[mm]	460	630
Net weight	[Kg]	1350	2120
Gross weight with packing	[Kg]	1850	3000
Packing dimensions (length x width x height)	[m]	2,58x0,98x1,7	3,11x1,42x1,95

F SERIES

your choice for:



Mechanical skill

Creativity

Multifunctional use

Precision

Ample cross table

Complete equipment

Reliability



ø 35 mm



45 cm²



M30



0,9/1,5 Kw



MT 4



200 mm



383 mm

|| STANDARD EQUIPMENT

- Adjusting of the vertical position of the head by geared-motor
- 45° tilting head on both sides of the central axis
- Hardened and ground high quality steel gears
- Gear box lubrication by automatic pump
- Automatic guide greasing by manual pump
- High/low speed range selector
- Coolant tank and pump in machine base
- Worklight
- Co-ordinate cross table
- Automatic feed and cut-off by electromagnetic clutch
- Front hand wheel for fine feed work
- Depth scale and adjustable depth stop
- Automatic tool ejector
- Electric equipment integrated on machine's head
- Emergency STOP push button
- Spindle reversing switch
- Safety drill guard with microswitch
- CE mark

|| OPTIONAL EQUIPMENT

- RS** Automatic feed reversing system for tapping
- RPF** Pitch controlled tapping with braking system by speed inverter
- HGP** Master guide spindle and nut set
- HGP-S** Special master guide spindle and nut set
- ISO-30** ISO-30 spindle
- ISO-40** ISO-40 spindle
- SC** Column riser
- ENG X** Motorized geared box feed system in X axis
- ENG Y** Motorized geared box feed system in Y axis
- LDG-1** Digital read-out system for table axis (X) (Available also for 2 and 3 axis)
- MB** Security bimanual command
- LBC** Depth scale digital read-out system
- SC** Column riser
- PPZ** Set of collet holder, collets, key, nut and box

F SERIES

Drilling/Milling machine/Prismatic Column/ Gear transmission

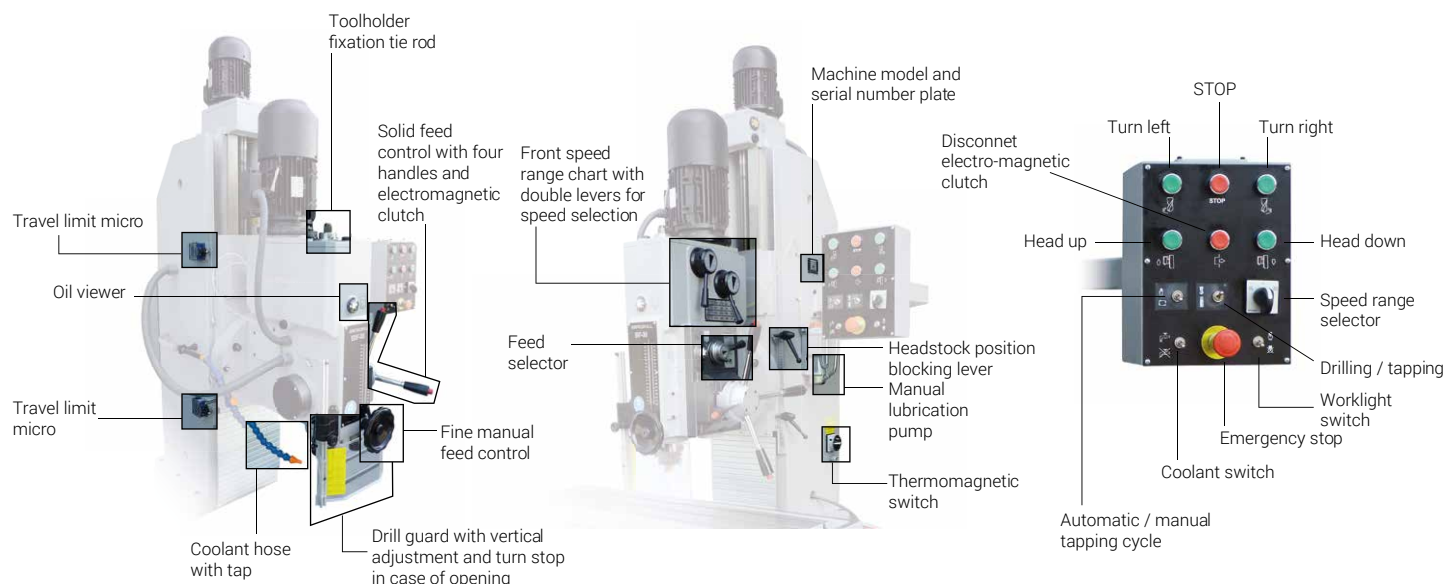

|| CHARACTERISTICS

EBF-35

Maximum drilling capacity in steel St. 50/60	[ø mm]	35
Maximum milling capacity in steel St. 50/60	[cm³/min]	55
Maximum tapping capacity in steel St. 50/60	[mm]	M 35
ISO taper (upon request)	[Nr.]	30
Morse Taper MT	[Nr.]	4
Maximum spindle stroke (drilling depth)	[mm]	180
Main motor power	[HP (Kw)]	1,2 / 2 (0,9/1,5)
Transmission		Gear box
Number of speeds		16
Speed range with motor at 750/1500 rpm 50 Hz 3Ph. Upon request: Motor at 1800/3600 rpm 60 Hz 3Ph. (125-2850 rpm)	[rpm]	94-135-189-207-271-303-347-416-497-606-695-760-995-1112-1520-2225 113-162-226-248-324-363-417-496-597-726-834-912-1194-1335-1824-2670
Feed		Automatic by electromagnetic clutch
Nr. of automatic feeds		3
Automatic feed range	[mm/rev]	0,1 - 0,18 - 0,24
Worktable dimensions (LxW).	[mm]	360 x 1220
Longitudinal movement of the table (X)	[mm]	700
Cross movement of the table (Y)	[mm]	360
Distance from spindle centre to column face	[mm]	390
Net weight	[Kg]	910
Gross weight with packing	[Kg]	1400
Packing dimensions (length x width x height)	[m]	1,68 x 1,68 x 2,52

C SERIES

your choice for:



Continuous speed range

Digital display of revolutions

Spindle reverse for tapping

Easy to run

State of the art technology

Industrial use

Full equipment



ø 40 mm
ø 50 mm



M 36
M 42



3Kw
4 Kw



MT 4
MT 4



200 mm
200 mm



ø 175 mm
ø 175 mm



360 mm
360 mm

|| STANDARD EQUIPMENT

- Wide continuous speed range in 3 steps
- Speed plate and selecting levers on head front
- Mechanical speed variator in "V" model
- Electronic speed variator in "VE" model
- Digital rpm counter in front "VE"
- Gear box lubrication by automatic pump
- Machine base with coolant tank and pump for tapping
- Worklight
- MGI Rotating and tilting table
- Automatic feed and cut-off by electromagnetic clutch
- Front hand wheel for fine feed work
- Depth scale and adjustable depth stop
- Automatic feed reversing system for tapping
- Automatic tool ejector
- Electric equipment integrated on machine's head.
- Emergency STOP push button
- Spindle reversing switch
- Safety drill guard with microswitch
- CE mark

|| OPTIONAL EQUIPMENT

- AR** 50% lowered feed rate range
- LBC** Depth scale digital read-out system

C SERIES

Prismatic Column - Gear transmission

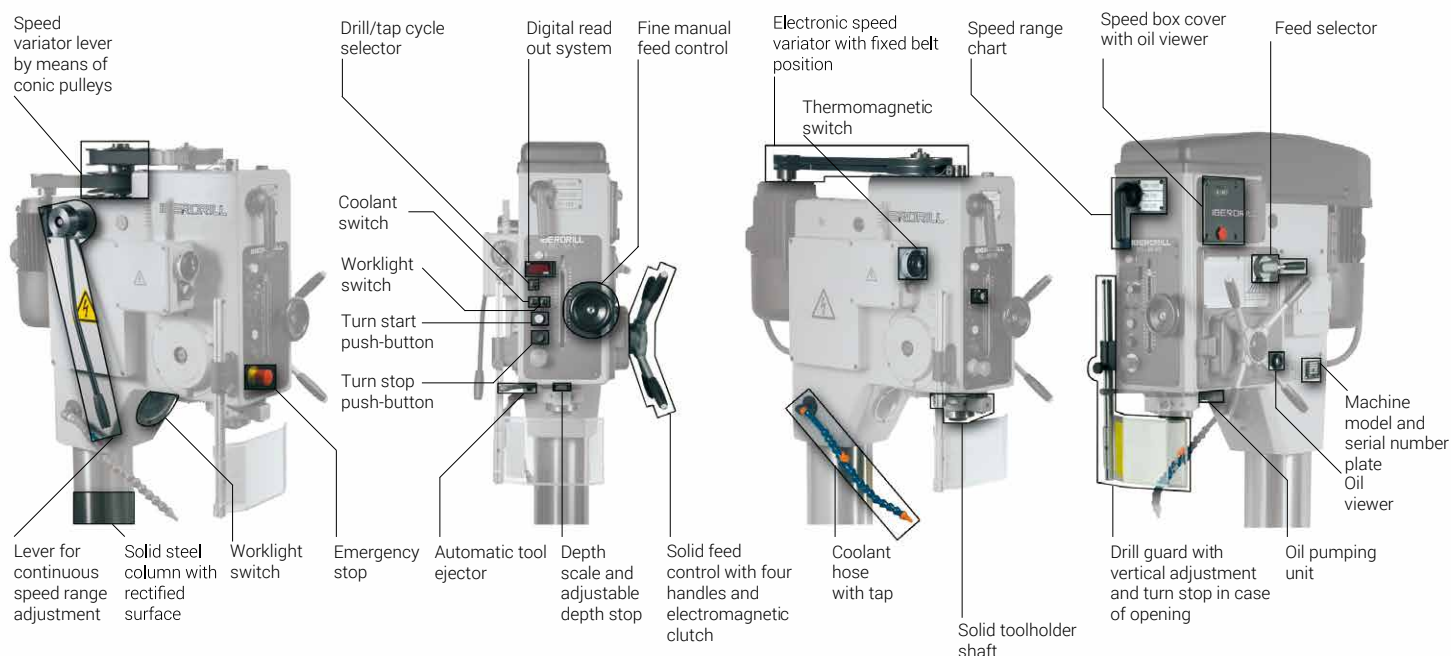

CHARACTERISTICS

BC-40 V

BC-40 VE

BC-50 V

BC-50 VE

Maximum drilling capacity in steel St. 50/60	[ø mm]	40		50	
Maximum drilling capacity in cast iron 200 Brinell	[ø mm]	50		60	
Maximum tapping capacity in steel St. 50/60	[mm]	M 36		M 42	
Maximum tapping capacity in cast iron 200 Brinell	[mm]	M 42		M 50	
Morse Taper MT	[Nr.]	4		4	
Maximum spindle stroke (drilling depth)	[mm]	200		200	
Main motor power	[HP (Kw)]	4 (3)		5,5 (4)	
Coolant pump motor power	[HP (Kw)]	0,10 (0,07)			
Transmission		Belt / Gear			
Number of speeds		Continuous			
Speed variator type		Mechanical	Electronic	Mechanical	Electronic
Speed range with motor at 1500 rpm 50 Hz 3Ph.	[rpm]	60 a 200	30 a 300	60 a 200	30 a 300
Speed range selection in 3 steps		200 a 600	90 a 900	200 a 600	90 a 900
Upon request motor at 1800 rpm 60 Hz 3Ph.		600 a 1500	190 a 1900	600 a 1500	190 a 1900
Feed		Automatic by electromagnetic clutch			
Number of automatic feeds		4			
Automatic feed range	[mm/rev]	0,1-0,2-0,3-0,4			
Worktable dimensions (LxW).	[mm]	550x550			
Column diameter	[mm]	175			
Distance from spindle centre to column face	[mm]	360			
Net weight	[Kg]	660		760	
Gross weight with packing	[Kg]	750		850	
Packing dimensions (length x width x height)	[m]	2,2x0,7x1,2		2,2x0,7x1,3	

CABINETS / BASES / CONTAINERS / LIGHT



PKA
Floor cabinet with 2 shelves.
Available for **EK/T** series.



PKB
Floor cabinet with door and drawer. Available for **EK/T** series.



ERC
Coolant system
(independent container).
Available for **EK/T** series.

TABLES INCLUDING SUPPORTS



MF
Fixed table.
Standard for **EK/T/Z/X(32-34)** series.



MG
Rotating table plate.
Optional for **EKL/TL** series.



MGI
Rotating table plate and tilting support.
Available for **Z/X/A/B/C** series.



MGM
Reversible rotating tiltable with vice.
Available for **Z/X (32/34)** series.

CROSS TABLES



MB1
Cross table.
X = 220 mm.
Y = 140 mm.
Table net weight = 25 kg.
Available for **EK/T** series.

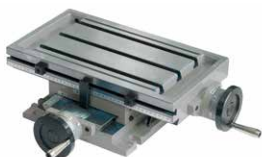

MB2
Cross table.
X = 280 mm.
Y = 180 mm.
Table net weight = 40 kg.
Available for **Z/X** series.



MB3
Cross table.
X = 400 mm.
Y = 180 mm.
Table net weight = 52 kg.
Available for **Z/X(32-34)** series.



MB4
Cross table.
X = 500 mm.
Y = 250 mm.
Table net weight = 93 kg.
Available **Z/X/A/B/C** series.



ERB

"T" slotted machine base with coolant pump.
Standard for **Z/X/A/B/C** series.



PV

Safety drill guard against chips with a micro-switch.
Standard in all series.



EL

Worklight.
Standard in all series



MB5

Cross table.
X = 700 mm.
Y = 250 mm.
Table net weight = 150 kg.
Available for **Z/X(40)/A/B/C** series.

SPEED CONTROL / MEASURE / TAPPING



VE

Standard for **Z(34-40)**, **BC-40VE** and **BC-50VE**.
Available for other models upon request.



TAK

Digital rpm counter.
Standard for **Z (34-40)** and **C** series.
Available for other models upon request.



LBC

Depth scale read-out system.
Available for all series.



LDG

Digital read-out system for the table.

SPEED CONTROL / MEASURE / TAPPING



CN

Pneumatic counterbalance for spindle return (recommended with multi-spindle head applications).
Available for **X/A/B/P** series.



ACNL

Automatic drilling cycle with rapid approach, working feed and rapid retract.
Available for **B** models on **Z/X/B/P** series.



CI

Integral drilling cycle with encoder (recommended for tube and profile drilling, deep drilling operations, etc.).
Available for **B** models on **Z/X/B/P** series.



HB

Hydro-pneumatic power feed unit.
Available for **EK/T/Z/X** series (only for manual feed models).

STANDARD ASSEMBLY FOR JOBS USING MULTI-SPINDLE HEADS

Accessories and functions

ACNL

Automatic drilling cycle with rapid approach, working feed and rapid retract, with additional pneumatic counterweight function for the multi-spindle head.

UC

Union, dragging cone and assembly of the multi-spindle head.

CM

Multi-spindle head with fixed or adjustable (see picture) spindles.

GM

Multi-spindle head guide rod.

PM

START/STOP and emergency STOP control extensión.

SC

Column riser of 200 mm for greater distance between spindle nose and worktable.

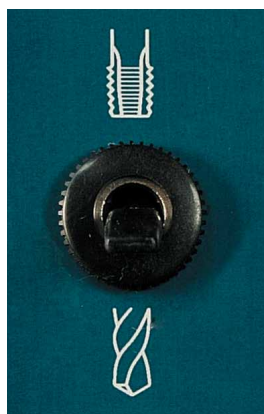

RS

Automatic feed reversing for tapping. Standard for **Z(34-40)** y **C** serie. Available for all series.



RPF

Automatic tapping cycle by lead screw system with brake motor for spindle reverse. Available for **X/A/B/P** series.



HGP

Master guide spindle and nut set. Available for **X/A/B/P** series.



CM

Multi-spindle drilling heads with fixed or adjustable spindles. Available for all series.



AR

50% lowered feed rate range. Available for **A/B/C** series.



MQL

Microlubrification system. Available for all series.

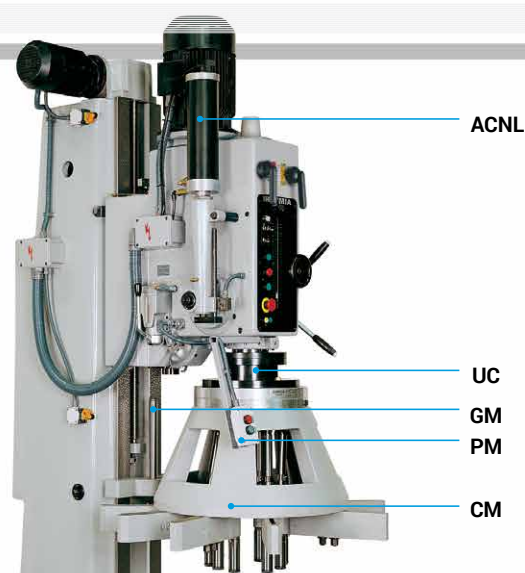
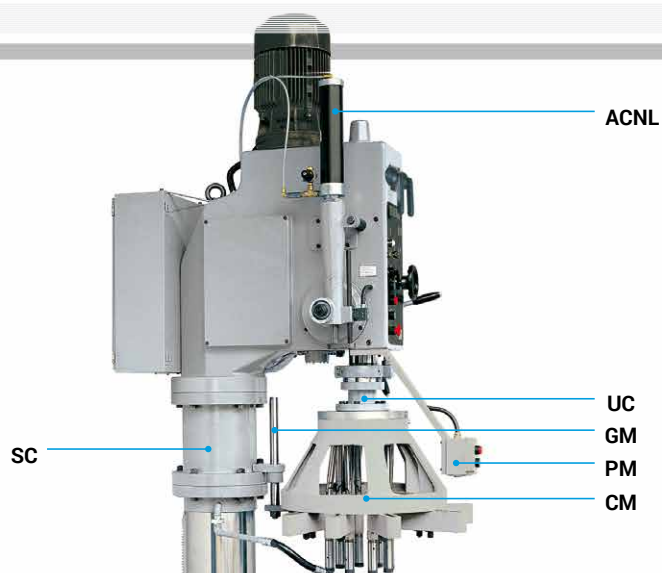

STANDARD VICES



SL-116

Vise with fixed base (Light Series).
Maximum opening: 116 mm
Jaw width: 105 mm
Jaw height: 31,5 mm
Net weight: 8,5 kg.
Available for **EK/T/Z/X/A/B/C** series.



SL-160

Vise with fixed base (Light Series).
Maximum opening: 160 mm
Jaw width: 125 mm
Jaw height: 41,5 mm
Net weight: 4,7 kg.
Available for **EK/T/Z/X/A/B/C** series.



FL-116

Vise with fixed base.
Maximum opening: 116 mm.
Jaw width: 100 mm.
Jaw height: 31,5 mm.
Net weight: 9 Kg.
Available for **Z/X/A/B/C** series.



FL-157

Vise with fixed base.
Maximum opening: 157 mm.
Jaw width: 125 mm.
Jaw height: 41,5 mm.
Net weight: 15 Kg.
Available for **Z/X/A/B/C** series.

RAPID CLOSE AND SELF-CENTERING VICES



FR-80

Opening-cam rapid close vice.
Maximum opening: 80 mm.
Jaw width: 80 mm.
Jaw height: 20 mm.
Net weight: 6 Kg.
Available for all series.



FR-125

Opening-cam rapid close vice.
Maximum opening: 125 mm.
Jaw width: 125 mm.
Jaw height: 30 mm.
Net weight: 23 Kg.
Available for all series.



FK-103

Self-centering vice.
Maximum opening: 103 mm.
Jaw width: 103 mm.
Jaw height: 20 mm.
Net weight: 12 Kg.
Available for all series.

CHUCKS, FOOT PEDALS...



PL

Manual jaw chuck.
Available for all series.



PN

Pneumatic jaw chucks.
Available for all series.



PST

Cycle or spindle turn START foot pedal.

PSR

Spindle turn reverse foot pedal (for tapping)
Available for all series.



PEM

Emergency STOP foot pedal.
Available for all series.



FS-150

Vise with fixed base
(Heavy Series).
Maximum opening: 150 mm.
Jaw width: 150 mm.
Jaw height: 44 mm.
Net weight: 28 Kg.
Available for **A/B/C/P/F** series.



FG-150

Vise with swiveling base
(Heavy Series).
Maximum opening: 150 mm.
Jaw width: 150 mm.
Jaw height: 44 mm.
Net weight: 37 Kg.
Available for **A/B/C/P/F** series.

TOOL HOLDERS



DRILL-CHUCKS

Self-centering drill-chuck from dia. 3 to dia.16 Morse taper 3 & 4.
Available for all series.



TAPHOLDER

Morse taper, tapholder and tapping collets.



REDUCING SLEEVES

Self-centering drill-chuck from dia.1 to 16 Morse taper 3-4 & 5.
Available for all series.



ISO 40

Spindle with quick change nut.
Available for **EBP-50** models.

ISO 50

Spindle with quick change nut.
Available for **EBP-70** models.



PMC

Pendent control panel
(all functions).
Available for **P** serie.

PROFESSIONAL

New Series Iberdrill PROFESSIONAL Drilling machines

In PROFESSIONAL areas with functionally supporting duties, as it the manufacturing, workshop and repair can be, enterprises need drills with a lower degree of utilization. In line with this real demand, the well-known **IBERDRILL** machines, which are dimensioned for heavy continuous loads and with a high utilization rate, reach the limit of their economic efficiency.

Therefore, with the new **IBERDRILL PROFESSIONAL** series, we offer a wide range of drills, which - although they have the well-known quality and robustness, but with the only necessary equipment and with the dimension of required lower operating times - have a **favorable price performance ratio** on the international market.

The arrangement of the new **IBERDRILL PROFESSIONAL** series is based on 50 years of drilling mechanical engineering and the incorporation of the basic specifications of the well-known and up-to-date **IBERDRILL** machines.

IBERDRILL PROFESSIONAL machines are subject to the same high quality requirements and outgoing strict performance tests at the Spanish-Basque production site, which are valid for all **IBERDRILL** machines.

***IBERDRILL PROFESSIONAL-drills
for your need of utilization – your
conviction!***



MG: Rotating table plate

R: Coolant

MG+R: Rotating table plate + coolant



ø 32 mm



M 20



1,8/3,2 CV



MT 3



120 mm



100 mm



250 mm



|| STANDARD EQUIPMENT

- Depth scale and adjustable depth stop
- Automatic tool ejector
- Low voltage electric equipment
- Security microswitch on cover
- Emergency STOP push button
- Spindle reversing switch
- Electric equipment integrated on machine's head
- Safety drill guard with microswitch
- Table with "T" slots
- "CE" mark

|| OPTIONAL EQUIPMENT

- Worklight
- Machined base with coolant tank
- Automatic feed reversing system for tapping
- Rotating table plate

|| CHARACTERISTICS

Maximum drilling capacity on 60 kg. steel	[ø mm]	32
Maximum drilling capacity on 200 HB. cast iron	[ø mm]	35
Maximum tapping capacity on 60 kg. steel	[mm]	M 20
Maximum tapping capacity on 200 HB. cast iron	[mm]	M 24
Morse Taper MT	[Nr.]	3
Drilling depth	[mm]	120
Tapping depth	[mm]	90
Feed		Manual
2 speed motor power	[HP]	1,8 / 3,2
Transmission		Belt-pulleys
Number of speeds		10
Speed range with 2 speed motor 750/1500 rpm 50 Hz 3Ph.	[rpm]	245-355-490-710-835-1240-1670-2000-2480-4000
Table dimensions (WxL)	[mm]	300 x 270
Column diameter	[mm]	100
Distance from spindle centre to column face	[mm]	250
Distance spindle-table	[mm]	Min. 105 / Max. 655
Distance spindle-base	[mm]	1.190
Net weight	[Kg]	260
Gross weight with packing	[Kg]	320
Packing volume	[m³]	1,03

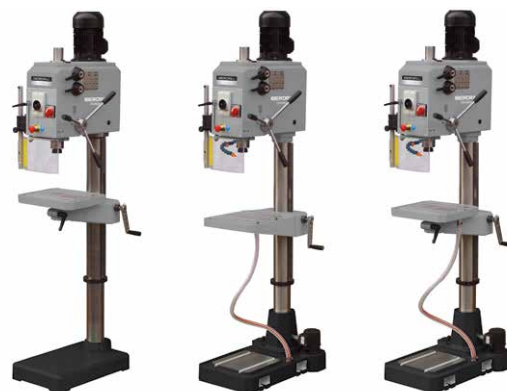

MG: Rotating table plate

R: Coolant

MG+R: Rotating table plate + coolant



ø 32 mm



M 24



2,5/3,5 CV



MT 3



120 mm



100 mm



250 mm

|| STANDARD EQUIPMENT

- Depth scale and adjustable depth stop
- Automatic tool ejector
- Low voltage electric equipment
- Emergency STOP push button
- Spindle reversing switch
- Electric equipment integrated on machine's head
- Safety drill guard with microswitch
- Table with "T" slots
- Thermomagnetic switch
- "CE" mark

|| OPTIONAL EQUIPMENT

- Worklight
- Machined base with coolant tank
- Automatic feed reversing system for tapping
- Rotating table plate

|| CHARACTERISTICS

Maximum drilling capacity on 60 kg. steel	[ø mm]	32
Maximum drilling capacity on 200 HB. cast iron	[ø mm]	35
Maximum tapping capacity on 60 kg. steel	[mm]	M 24
Maximum tapping capacity on 200 HB. cast iron	[mm]	M 27
Morse Taper MT	[Nr.]	3
Drilling depth	[mm]	120
Tapping depth	[mm]	90
Feed		Manual
2 speed motor power	[HP]	2,5 / 3,5
Transmission		Gear box
Number of speeds		8
Speed range with 2 speed motor 1500/3000 rpm 50 Hz 3Ph.	[rpm]	65-125-185-365-540-1055-1560-3060
Table dimensions (WxL)	[mm]	300 x 270
Column diameter	[mm]	100
Distance from spindle centre to column face	[mm]	250
Distance spindle-table	[mm]	Min. 85 / Max. 635
Distance spindle-base	[mm]	1.170
Net weight	[Kg]	260
Gross weight with packing	[Kg]	320
Packing volume	[m³]	1,03



MG: Rotating table plate



R: Coolant



MG+R: Rotating table plate + coolant



Ø 32 mm



M 24



2,5/3,5 CV



MT 3



120 mm



100 mm



250 mm

|| STANDARD EQUIPMENT

- Depth scale and adjustable depth stop
- Automatic tool ejector
- Low voltage electric equipment
- Emergency STOP push button
- Spindle reversing switch
- Electric equipment integrated on machine's head
- Safety drill guard with microswitch
- Table with "T" slots
- Thermomagnetic switch
- "CE" mark

|| OPTIONAL EQUIPMENT

- Worklight
- Machined base with coolant tank
- Automatic feed reversing system for tapping
- Rotating table plate



|| CHARACTERISTICS

Maximum drilling capacity on 60 kg. steel	[Ø mm]	32
Maximum drilling capacity on 200 HB. cast iron	[Ø mm]	35
Maximum tapping capacity on 60 kg. steel	[mm]	M 24
Maximum tapping capacity on 200 HB. cast iron	[mm]	M 27
Morse Taper MT	[Nr.]	3
Drilling depth	[mm]	120
Nr. and range of automatic feeds	[mm/rev.]	(2) 0,10 - 0,20
Feed		Automatic
2 speed motor power	[HP]	2,5 / 3,5
Transmission		Gear box
Number of speeds		8
Speed range with 2 speed motor 1500/3000 rpm 50 Hz 3Ph.	[rpm]	65-125-185-365-540-1055-1560-3060
Table dimensions (WxL)	[mm]	300 x 270
Column diameter	[mm]	100
Distance from spindle centre to column face	[mm]	250
Distance spindle-table	[mm]	Min. 85 / Max. 635
Distance spindle-base	[mm]	1.170
Net weight	[Kg]	260
Gross weight with packing	[Kg]	320
Packing volume	[m³]	1,03



MGI: Rotating and tilting table

R: Coolant

MGI+R: Rotating and tilting table + Coolant



ø 35 mm



M 27



4 CV



MT 4



150 mm



125 mm



300 mm

|| STANDARD EQUIPMENT

- Depth scale and adjustable depth stop
- Automatic tool ejector
- Low voltage electric equipment
- Security microswitch on cover
- Electronic inverter with digital rpm counter
- Emergency STOP push button
- Spindle reversing switch
- Electric equipment integrated on machine's head
- Safety drill guard with microswitch
- Table with "T" slots
- Automatic feed reserving system for tapping
- "CE" mark

|| OPTIONAL EQUIPMENT

- Worklight
- Machined base with coolant tank
- Rotating table plate

|| CHARACTERISTICS

Maximum drilling capacity on 60 kg. steel	[ø mm]	35
Maximum drilling capacity on 200 HB. cast iron	[ø mm]	40
Maximum tapping capacity on 60 kg. steel	[mm]	M 27
Maximum tapping capacity on 200 HB. cast iron	[mm]	M 33
Morse Taper MT	[Nr.]	4
Drilling depth	[mm]	150
Feed		Manual
Motor power	[HP]	4
Transmission		Belt-pulleys
Number of speeds		Variable by electronic inverter
Speed range with motor 1500 rpm 50 Hz 3Ph.	[rpm]	100 - 2000
Table dimensions (WxL)	[mm]	400 x 420
Column diameter	[mm]	125
Distance from spindle centre to column face	[mm]	300
Distance spindle-table	[mm]	Min. 90 / Max. 890
Distance spindle-base	[mm]	1.250
Net weight	[Kg]	345
Gross weight with packing	[Kg]	395
Packing volume	[m³]	1,52

IZA-35



MGI: Rotating and tilting table



R: Coolant



MGI+R: Rotating and tilting table + Coolant



ø 35mm



M 27



4 CV



MT 4



150 mm



125 mm



300 mm

|| STANDARD EQUIPMENT

- Depth scale and adjustable depth stop
- Automatic tool ejector
- Low voltage electric equipment
- Security microswitch on cover
- Electronic inverter with digital rpm counter
- Emergency STOP push button
- Spindle reversing switch
- Electric equipment integrated on machine's head
- Safety drill guard with microswitch
- Table with "T" slots
- Automatic feed reserving system for tapping
- "CE" mark

|| OPTIONAL EQUIPMENT

- Worklight
- Machined base with coolant tank
- Rotating table plate



|| CHARACTERISTICS

Maximum drilling capacity on 60 kg. steel	[ø mm]	35
Maximum drilling capacity on 200 HB. cast iron	[ø mm]	40
Maximum tapping capacity on 60 kg. steel	[mm]	M 27
Maximum tapping capacity on 200 HB. cast iron	[mm]	M 33
Morse Taper MT	[Nr.]	4
Drilling depth	[mm]	150
Nr. and range of automatic feeds	[mm/rev.]	(3) 0,10-0,20-0,30
Feed		Automatic
Motor power	[HP]	4
Transmission		Belt
Number of speeds		Variable by electronic inverter
Speed range with motor 1500 rpm 50 Hz 3Ph.	[rpm]	100 - 2000
Table dimensions (WxL)	[mm]	400 x 420
Column diameter	[mm]	125
Distance from spindle centre to column face	[mm]	300
Distance spindle-table	[mm]	Min. 90 / Max. 890
Distance spindle-base	[mm]	1.250
Net weight	[Kg]	360
Gross weight with packing	[Kg]	410
Packing volume	[m³]	1,52



MGI: Rotating and tilting table

R: Coolant

MGI+R: Rotating and tilting table + Coolant



ø 40 mm



M 30



1,8/3,2 CV



MT 4



150 mm



125 mm



300 mm

|| STANDARD EQUIPMENT

- Depth scale and adjustable depth stop
- Automatic tool ejector
- Low voltage electric equipment
- Security microswitch on cover
- Emergency STOP push button
- Spindle reversing switch
- Electric equipment integrated on machine's head
- Safety drill guard with microswitch
- Table with "T" slots
- "CE" mark

|| OPTIONAL EQUIPMENT

- Worklight
- Machined base with coolant tank
- Automatic feed reversing system for tapping
- Rotating and tilting table

|| CHARACTERISTICS

Maximum drilling capacity on 60 kg. steel	[ø mm]	40
Maximum drilling capacity on 200 HB. cast iron	[ø mm]	45
Maximum tapping capacity on 60 kg. steel	[mm]	M 30
Maximum tapping capacity on 200 HB. cast iron	[mm]	M 32
Morse Taper MT	[Nr.]	4
Drilling depth	[mm]	150
Feed		Manual
2 speed motor power	[HP]	1,8 / 3,2
Transmission		Mechanical variator
Number of speeds		Variable
Speed range with motor 750/1500 rpm 50 Hz 3Ph.	[rpm]	80 - 1.170
Table dimensions (WxL)	[mm]	400 x 420
Column diameter	[mm]	125
Distance from spindle centre to column face	[mm]	300
Distance spindle-table	[mm]	Min. 150 / Max. 950
Distance spindle-base	[mm]	1.310
Net weight	[Kg]	295
Gross weight with packing	[Kg]	345
Packing volume	[m³]	1,52



MG: Rotating and tilting table



R: Coolant



MG+R: Rotating and tilting table + Coolant



ø 40 mm



M 30



1,8/3,2 CV



MT 4



150 mm



125 mm



300 mm

|| STANDARD EQUIPMENT

- Depth scale and adjustable depth stop
- Automatic tool ejector
- Low voltage electric equipment
- Security microswitch on cover
- Emergency STOP push button
- Spindle reversing switch
- Electric equipment integrated on machine's head
- Safety drill guard with microswitch
- Table with "T" slots
- "CE" mark

|| OPTIONAL EQUIPMENT

- Worklight
- Machined base with coolant tank
- Automatic feed reversing system for tapping
- Rotating and tilting table



|| CHARACTERISTICS

Maximum drilling capacity on 60 kg. steel	[ø mm]	40
Maximum drilling capacity on 200 HB. cast iron	[ø mm]	45
Maximum tapping capacity on 60 kg. steel	[mm]	M 30
Maximum tapping capacity on 200 HB. cast iron	[mm]	M 32
Morse Taper MT	[Nr.]	4
Drilling depth	[mm]	150
Feed		Automatic
Nr. and range of automatic feeds	[mm/rev.]	(2) 0,10 - 0,20
2 speed motor power	[HP]	1,8 / 3,2
Transmission		Mechanical variator
Number of speeds		Variable
Speed range with motor 750/1500 rpm 50 Hz 3Ph.	[rpm]	80 - 1.170
Table dimensions (WxL)	[mm]	400 x 420
Column diameter	[mm]	125
Distance from spindle centre to column face	[mm]	300
Distance spindle-table	[mm]	Min. 150 / Max. 950
Distance spindle-base	[mm]	1.310
Net weight	[Kg]	295
Gross weight with packing	[Kg]	345
Packing volume	[m³]	1,52

IXA-40



MGI: Rotating and tilting table

R: Coolant

MGI+R: Rotating and tilting table + Coolant



ø 40 mm



M 30



3CV



MT 4



150 mm



125 mm



300 mm

|| STANDARD EQUIPMENT

- Depth scale and adjustable depth stop
- Automatic tool ejector
- Low voltage electric equipment
- Thermomagnetic switch
- Emergency STOP push button
- Spindle reversing switch
- Electric equipment integrated on machine's head
- Safety drill guard with microswitch
- Table with "T" slots
- "CE" mark

|| OPTIONAL EQUIPMENT

- Worklight
- Machined base with coolant tank
- Automatic feed reversing system for tapping
- Rotating and tilting table

|| CHARACTERISTICS

Maximum drilling capacity on 60 kg. steel	[ø mm]	40
Maximum drilling capacity on 200 HB. cast iron	[ø mm]	44
Maximum tapping capacity on 60 kg. steel	[mm]	M 30
Maximum tapping capacity on 200 HB. cast iron	[mm]	M 32
Morse Taper MT	[Nr.]	4
Drilling depth	[mm]	150
Nr. and range of automatic feeds	[mm/rev.]	(3) 0,10 - 0,20 - 0,30
Feed		Automatic
Motor power	[HP]	3
Transmission		Gear box
Number of speeds		9
Speed range with motor 1500 rpm 50 Hz 3Ph.	[rpm]	132-194-277-319-466-666-883-1296-1852
Table dimensions (WxL)	[mm]	400 x 420
Column diameter	[mm]	125
Distance from spindle centre to column face	[mm]	300
Distance spindle-table	[mm]	Min. 90 / Max. 890
Distance spindle-base	[mm]	1.250
Net weight	[Kg]	400
Gross weight with packing	[Kg]	450
Packing volume	[m³]	1,52



R: Coolant



|| STANDARD EQUIPMENT

- Rotating and tilting table
- Automatic tool ejector
- Low voltage electric equipment
- Thermomagnetic switch
- Emergency STOP push button
- Spindle reversing switch
- Electric equipment integrated on machine's head
- Safety drill guard with microswitch
- Table with "T" slots
- "CE" mark

|| OPTIONAL EQUIPMENT

- Worklight
- Machined base with coolant tank
- Automatic feed reversing system for tapping



|| CHARACTERISTICS

Maximum drilling capacity on 60 kg. steel	[ø mm]	50
Maximum drilling capacity on 200 HB. cast iron	[ø mm]	54
Maximum tapping capacity on 60 kg. steel	[mm]	M 35
Maximum tapping capacity on 200 HB. cast iron	[mm]	M 38
Morse Taper MT	[Nr.]	4
Drilling depth	[mm]	180
Nr. and range of automatic feeds	[mm/rev.]	(3) 0,10 - 0,20 - 0,30
Feed		Automatic
Motor power	[HP]	4
Transmission		Gear box
Number of speeds		9
Speed range with motor 1500 rpm 50 Hz 3Ph.	[rpm]	132-194-277-319-466-666-883-1296-1852
Table dimensions (WxL)	[mm]	480 x 480
Column diameter	[mm]	150
Distance from spindle centre to column face	[mm]	350
Distance spindle-table	[mm]	Min. 80 / Max. 880
Distance spindle-base	[mm]	1.225
Net weight	[Kg]	490
Gross weight with packing	[Kg]	540
Packing volume	[m³]	1,52

BATTERIES

Round column drills

An ample fixed work table is often interesting because:

- It offers greater convenience for the positioning of the necessary parts and elements.
- Bulky or heavy pieces can be secured to the work table.

For these cases we offer our drill batteries, machines whose construction has one overriding rule: **Flexibility**.

As well as for bulky or heavy pieces, these assemblies are very interesting for jobs in big batches where the piece must receive more than one operation as it moves from one machine head to another, receiving each operation in turn. Naturally, each machine head can be equipped differently according to the function of the operation (automatic drilling cycle, automatic tapping cycle, spotfacing, etc.)

In **IBERDRILL** we offer you an endless number of combinations so that you can set up the machine to match your needs exactly. Tables of different widths and/or lengths can be combined with one, two, three... up to six machines heads. Detailed information on the different sizes of table and number of machine heads can be found on pages 47-49



SERIES

EK



18/25

T



25

Z



32

Z



34/40

X



32

X



34/40

A



40

B



40

C



40/50

A



50

B



50

Drill with fixed
table and rise
and falling
head

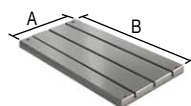

A x B

390 x 520



Dimensions in mm

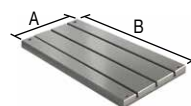

A x B

600 x 600

Drill with
extralarge fixed
table and rise
and falling head

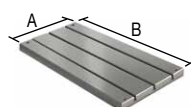

A x B

390 x 1040
390 x 1560
390 x 2080
390 x 2600
390 x 3120

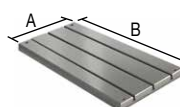

A x B

600 x 1200
600 x 2000
600 x 2680
600 x 3280
600 x 3880

Drill batteries 2
to 6
headstocks

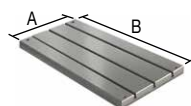

A x B

390 x 1040
390 x 1560
390 x 2080
390 x 2600
390 x 3120

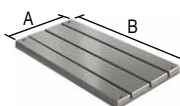

A x B

600 x 1200
600 x 2000
600 x 2680
600 x 3280
600 x 3880

BATTERIES

Prismatic column drills

These assemblies are extremely interesting in jobs of long production series where the piece undergoes more than one operation, moving from one machine head to another, receiving each operation in turn. Naturally, each machine head can be equipped differently according to the function of the operation (automatic drilling cycle, automatic tapping cycle, spotfacing, etc.). In many cases, these solutions are much more productive than machines such as machining centres and at a much lower cost.





BP-50 with extralarge table of 400 x 1500 mm.
for the drilling of rods using a multi-spindle
drilling head arranged in a line.



EBP-70 STANDARD
with PMC pendent control panel.

AVAILABLE TABLES

EBP-50

A x B

600 x 800
600 x 1400
600 x 2080
600 x 2680

EBP-70

A x B

600 x 1040
600 x 1840
600 x 2640
600 x 3440

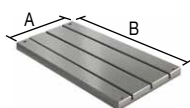

Dimensions in mm.



4BP-40 drill battery with a 400 x 2050 mm.
worktable supplied to a subcontractor of the railway industry.

SPECIAL CONSTRUCTIONS OF ROUND COLUMN



Simultaneous drilling of 76 holes in a paddle pallet.



2 Headstock drill battery (drill/tap by means of master guide spindle and nut set) for automation hinge.

SPECIAL CONSTRUCTIONS OF PRISMATIC COLUMN



Pneumatic self-centering 3 jaw chuck with synchronized open/close cycle.



2 Headstock drill battery including full guarding, automatic doors, working area division, synchronized clamping tools, automatic chip conveyor and outside control panel.



4 Positions rotating table for circular drill battery with synchronized hydraulic clamping tools.

Our experience comes from the manufacturing of hundreds of machines, hand in hand with our clients, carrying out in practice projects of "shared engineering": responding to the problems and needs that the client has with solutions that our experience tells us are the most appropriate. This sharing of needs and experience has led to ingenious solutions and machines.

Numerous applications of our machines are to be found in the automobile components sector, manufacturing of valves, flanges, etc., providing solutions for productivity and cost machine/piece which are unbeatable even by the most sophisticated numerical control machines.



Hydraulic self-centering clamping tools for automation hinge.

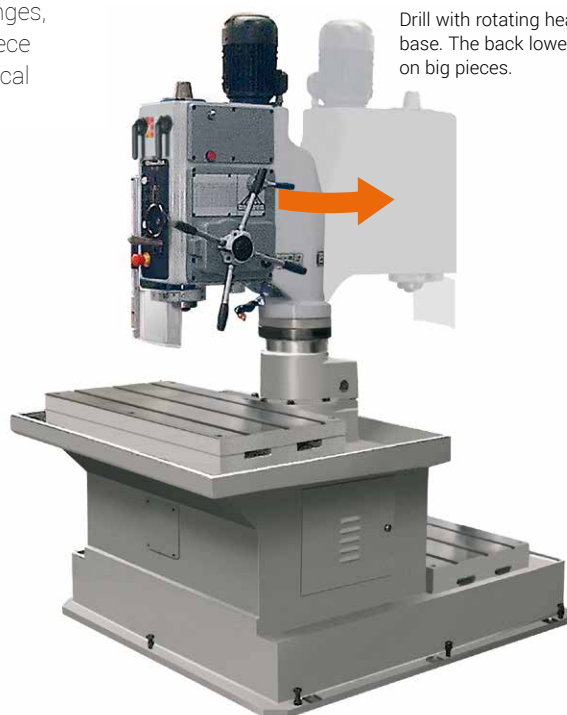

Drill with rotating head over double table base. The back lower table allows working on big pieces.



4 Positions circular drill battery:

- Position 1: loading with automatic regulation of the piece length.
- Position 2: drilling operation.
- Position 3: tapping operation.
- Position 4: automatic ejection of the pieces to the basket.



Multi-spindle headstock drilling detail of car handwheels.



Multi-spindle headstock drilling of car handwheels, under strict technical and security standards.

DIMENSIONS

Round column

EK SERIES

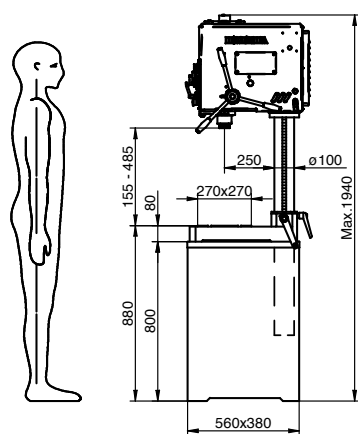

**EKS 18
EKS 25
EKS 30**

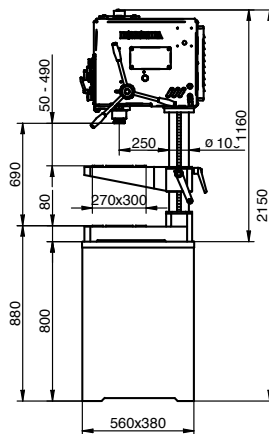

**EKM 18
EKM 25
EKM 30**

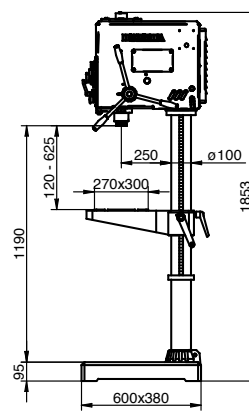

**EKL 18
EKL 25
EKL 30**

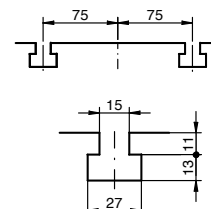

T SERIES

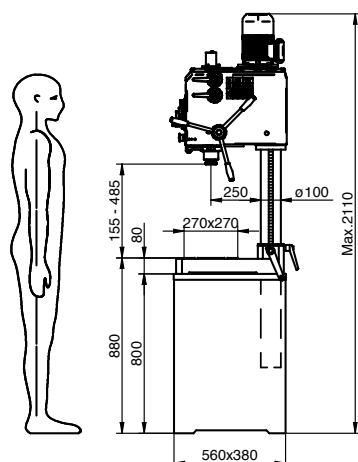

**TS 25
TS 30
TSA 25
TSA 30**

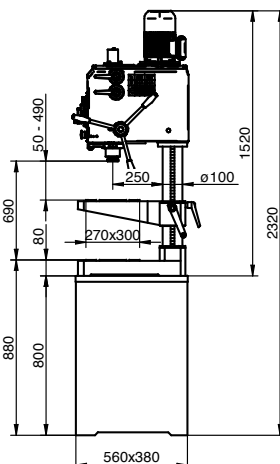

**TM 25
TM 30
TMA 25
TMA 30**

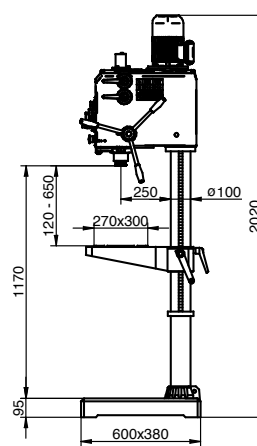

**TL 25
TL 30
TLA 25
TLA 30**

Z SERIES

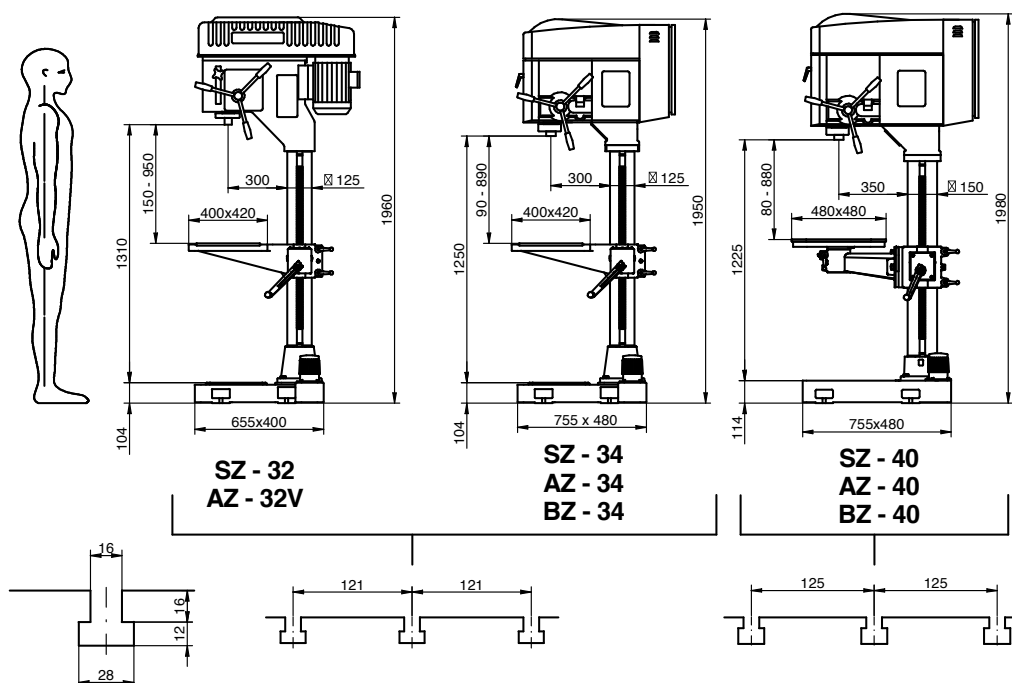

X SERIES

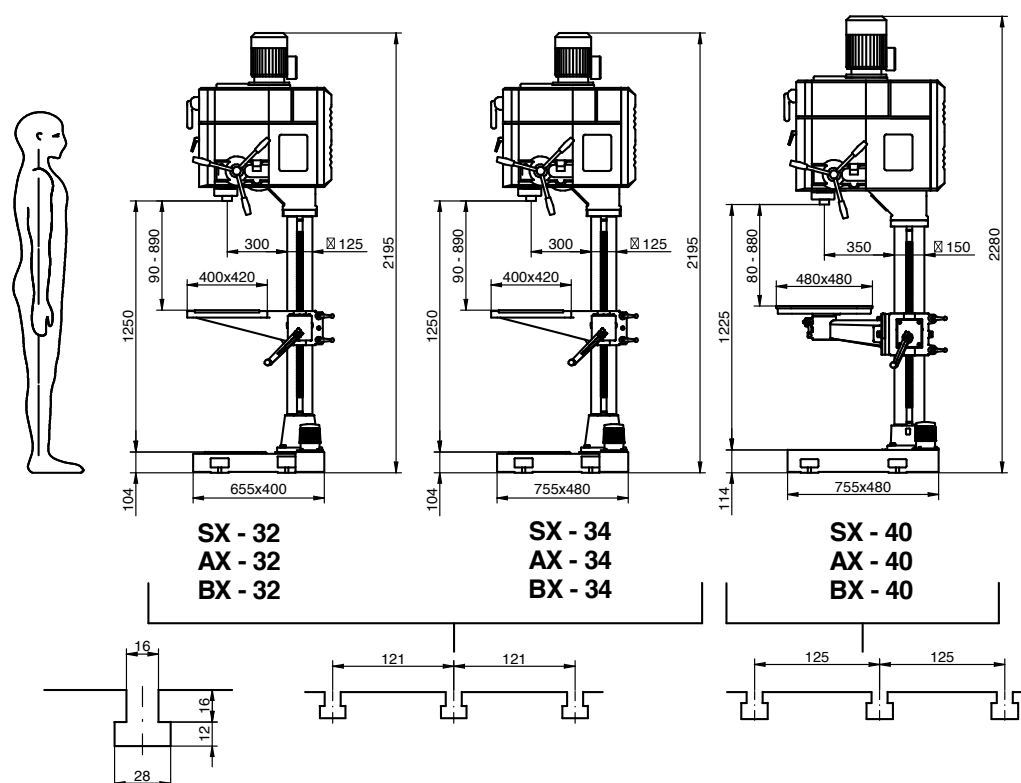

A&B SERIES

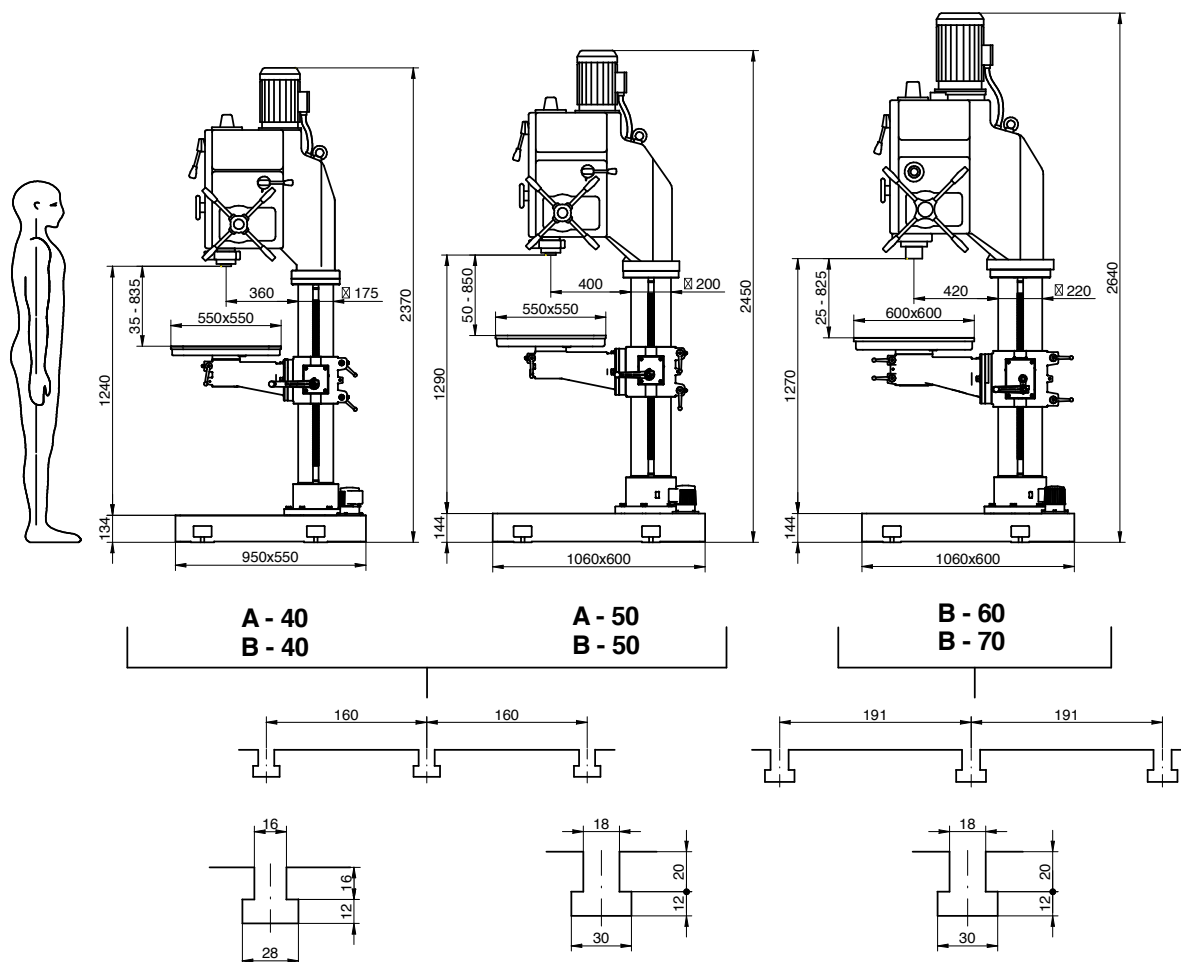

C SERIES

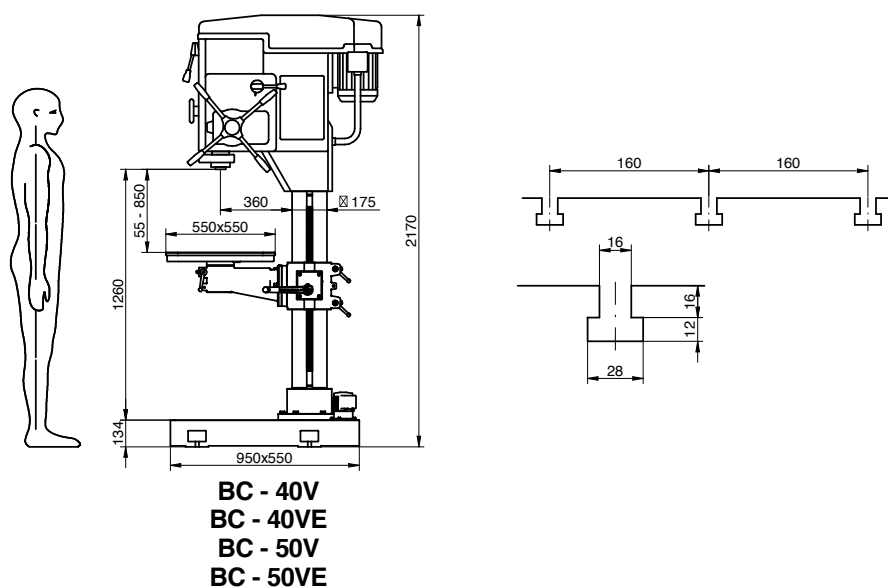

F SERIES

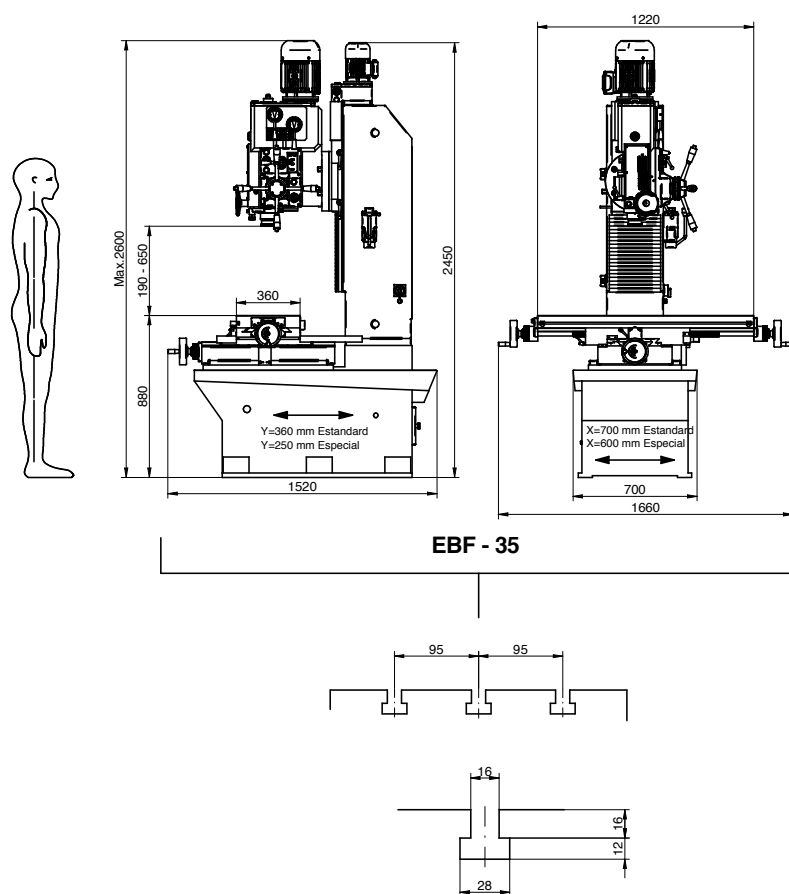

P SERIES

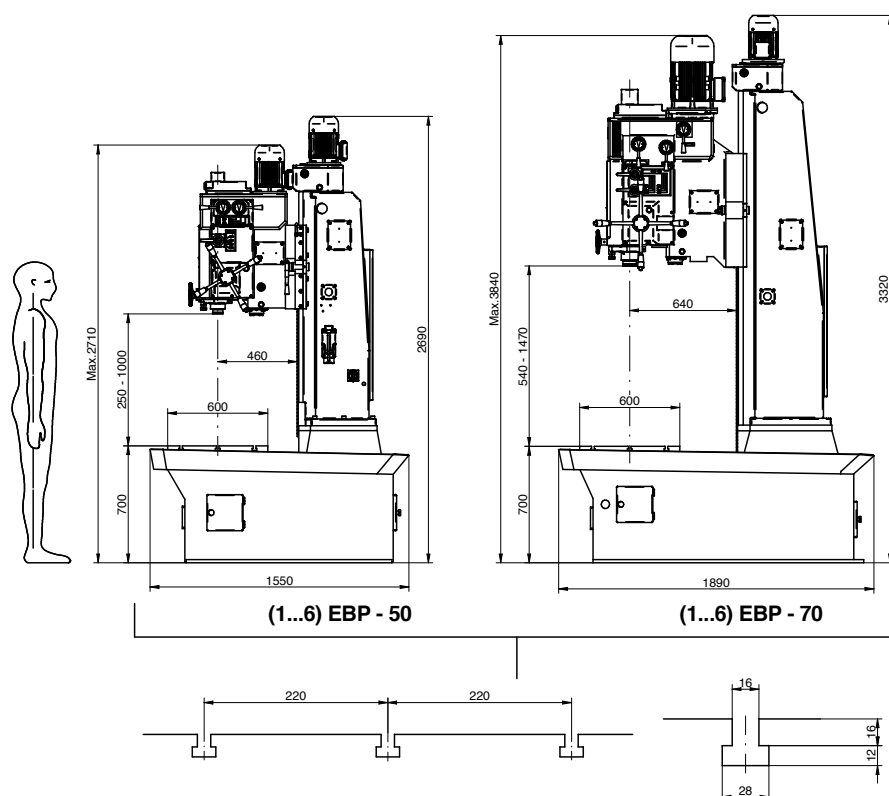

DIMENSIONS

Iberdrill PROFESSIONAL

IZ 32

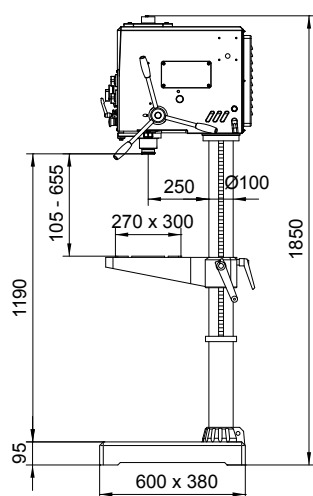

IX 32

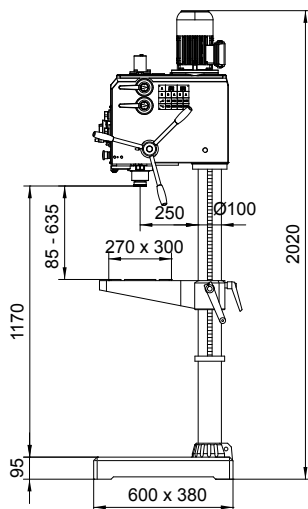

IXA 32

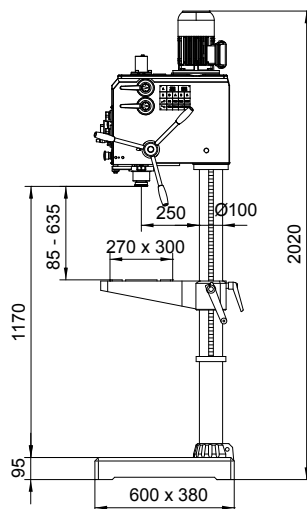

IZ 35

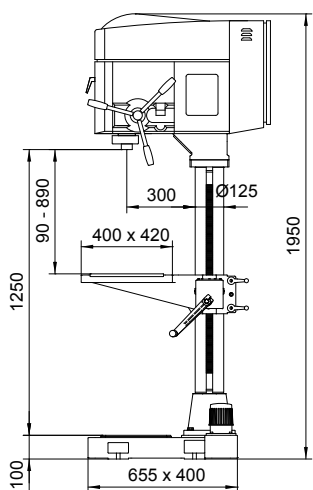

IZA 35

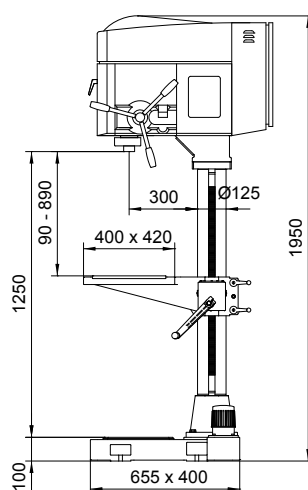

IZ 40

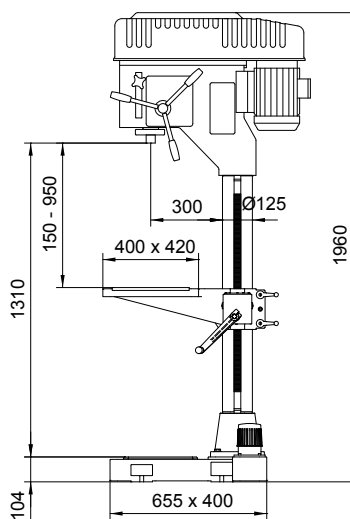

IZA 40

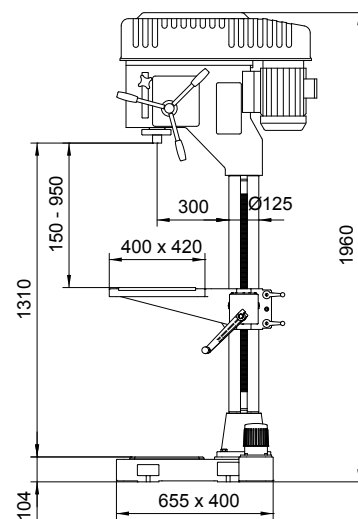

IXA 40

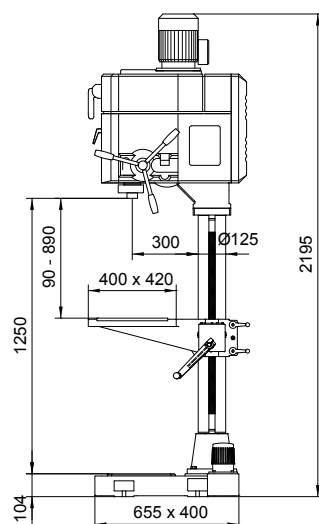

IXA 50

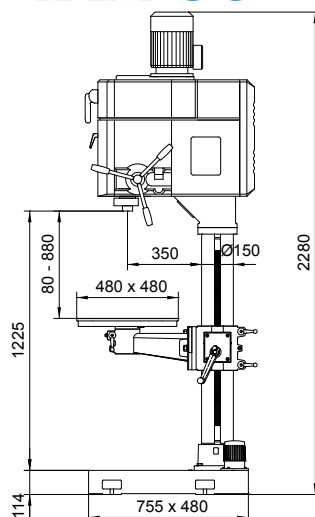

DIMENSIONS

Batteries

SERIE EK

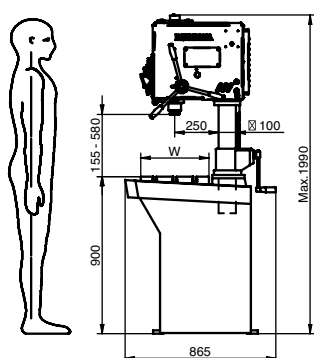

(1...6) EKS - 18
(1...6) EKS - 25

SERIE T

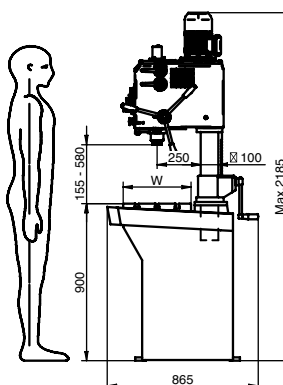

(1...6) TS - 25

SERIE Z

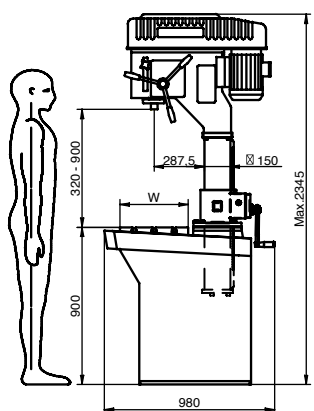

(1...6) SZ - 32
(1...6) AZ - 32V

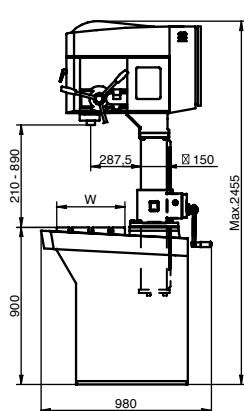

(1...6) SZ - 34
(1...6) AZ - 34
(1...6) BZ - 34

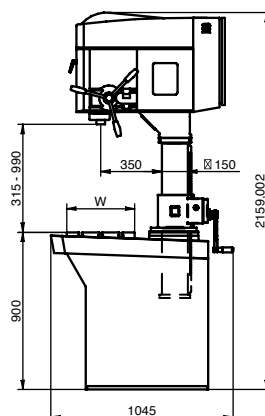

(1...6) SZ - 40
(1...6) AZ - 40
(1...6) BZ - 40

SERIE X

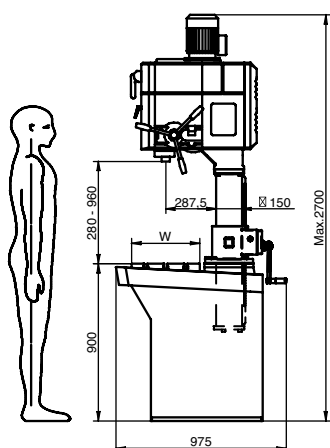

(1...6) SX - 32
(1...6) AX - 32

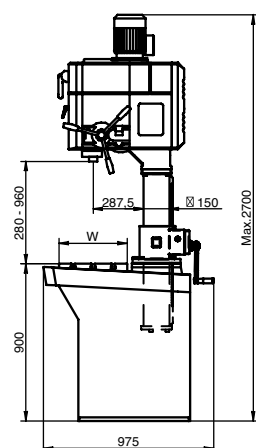

(1...6) SX - 34
(1...6) AX - 34
(1...6) BX - 34

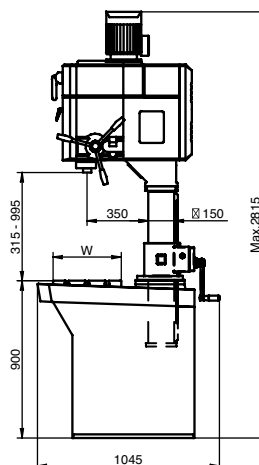

(1...6) SX - 40
(1...6) AX - 40
(1...6) BX - 40

SERIE C

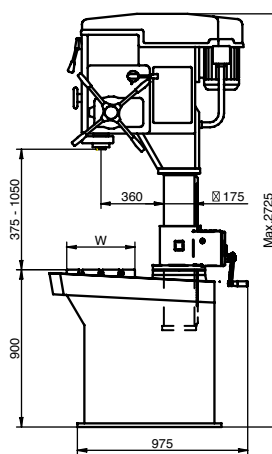

(1...6) BC - 40
(1...6) BC - 40 VE
(1...6) BC - 50
(1...6) BC - 50 VE

DIMENSIONS

Batteries

A&B SERIES

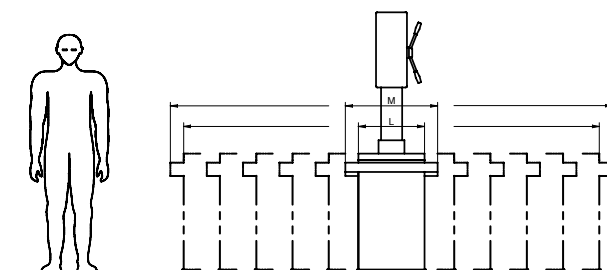
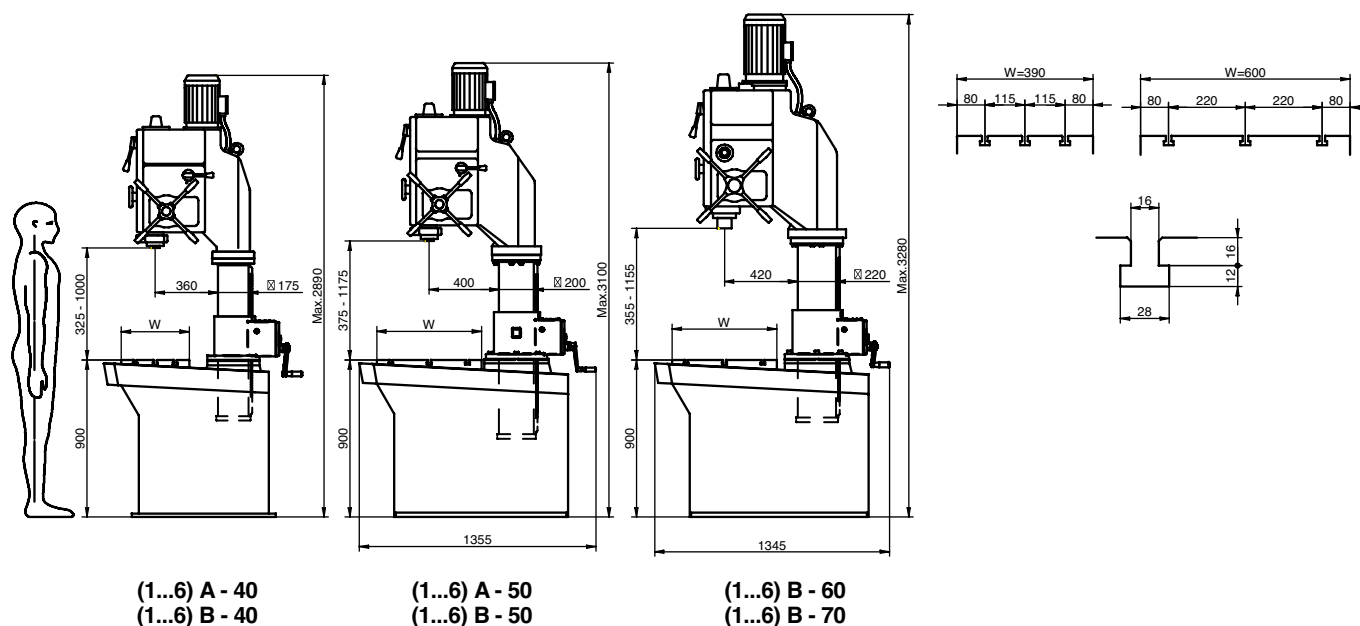

MODEL							W	L	M
1KS-18	1TS-25	1SZ-32 1AZ-32V	1SX-32 1AX-32	1SZ-34/40	1SX-34/40	1A-40	390	520	680
1KS-25				1AZ-34/40	1AX-34/40	1B-40			
1EKS-18				1BZ-34/40	1BX-34/40				
1EKS-25									

MODEL			W	L	M
1A-50	1B-60	1B-70	600	600	800
1B-50					

Optional tables

MODEL							W	L	M
1KS-18	1TS-25	1SZ-32 1AZ-32V	1SX-32 1AX-32	1SZ-34/40	1SX-34/40	1A-40	390	1040	1200
1KS-25				1AZ-34/40	1AX-34/40	1B-40	390	1560	1720
1EKS-18				1BZ-34/40	1BX-34/40		390	2080	2240
1EKS-25							390	2600	2760
							390	3120	3280

Optional tables

MODEL			W	L	M
1A-50 1B-50	1B-60	1B-70	600	1200	1400
			600	2000	2200
			600	2680	2880
			600	3280	3480
			600	3880	4080

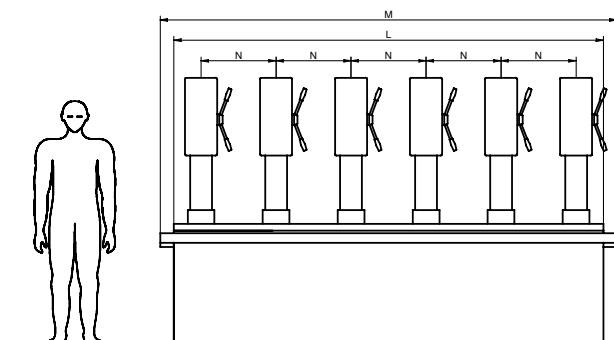

MODEL							W	L	M	N
S-18	2TS-25	2SZ-32 2AZ-32V	2SX-32 2AX-32	2SZ-34/40	2SX-34/40	2A-40	390	1040	1200	550
2KS-25				2AZ-34/40	2AX-34/40	2B-40				
2EKS-18				2BZ-34/40	2BX-34/40					
3KS-18	3TS-25	3SZ-32 3AZ-32V	3SX-32 3AX-32	3SZ-34/40	3SX-34/40	3A-40	390	1560	1720	550
3KS-25				3AZ-34/40	3AX-34/40	3B-40				
3EKS-18				3BZ-34/40	3BX-34/40					
4KS-18	4TS-25	4SZ-32 4AZ-32V	4SX-32 4AX-32	4SZ-34/40	4SX-34/40	4A-40	390	2080	2240	550
4KS-25				4AZ-34/40	4AX-34/40	4B-40				
4EKS-18				4BZ-34/40	4BX-34/40					
5KS-18	5TS-25	5SZ-32 5AZ-32V	5SX-32 5AX-32	5SZ-34/40	5SX-34/40	5A-40	390	2600	2760	550
5KS-25				5AZ-34/40	5AX-34/40	5B-40				
5EKS-18				5BZ-34/40	5BX-34/40					
6KS-18	6TS-25	6SZ-32 6AZ-32V	6SX-32 6AX-32	6SZ-34/40	6SX-34/40	6A-40	390	3120	3280	550
6KS-25				6AZ-34/40	6AX-34/40	6B-40				
6EKS-18				6BZ-34/40	6BX-34/40					

MODEL		W	L	M	N
2A-50	2B-60	600	1200	1400	700
2B-50	2B-70				
3A-50	3B-60	600	2000	2200	700
3B-50	3B-70				
4A-50	4B-60	600	2680	2880	700
4B-50	4B-70				
5A-50	5B-60	600	3120	3320	700
5B-50	5B-70				
6A-50	6B-60	600	3720	3920	700
6B-50	6B-70				

P SERIES

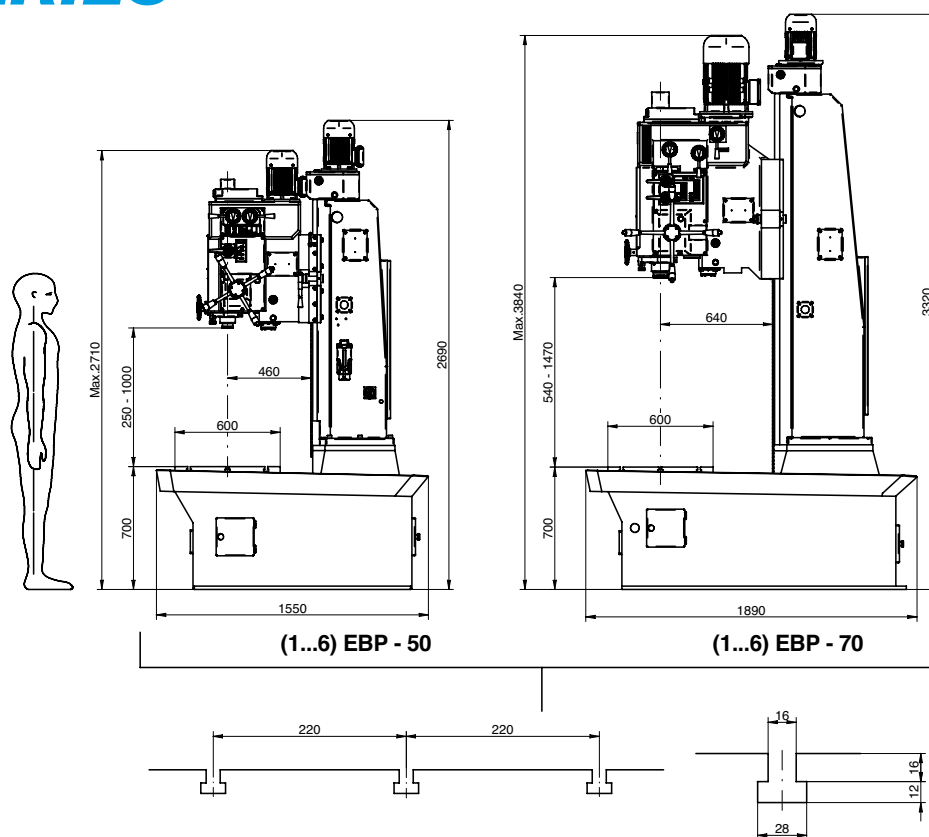

Prismatic Column

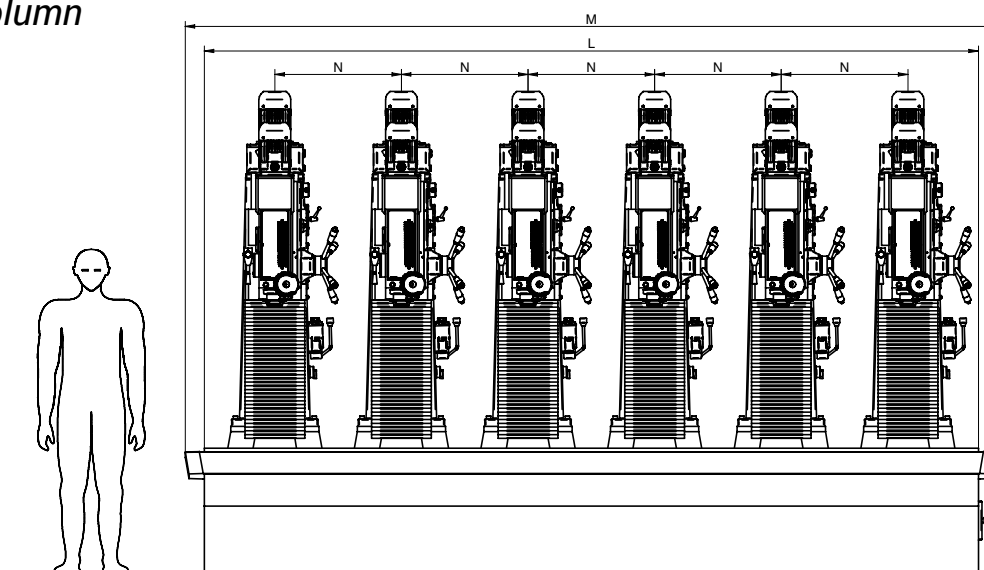

MODEL	LM	N	
EBP-50	800	1010	—
2EBP-50	1400	1610	700
3EBP-50	2080	2290	700
4EBP-50	2680	2890	700
5EBP-50	3480	3690	700
6EBP-50	4080	4290	700

MODEL	LM	N	
EBP-70	1040	1290	—
2EBP-70	1840	2090	800
3EBP-70	2640	2890	800
4EBP-70	3440	3690	800
5EBP-70	4160	4410	800
6EBP-70	5360	5610	800



www.erlogroup.com

Txerloie auzoa nº3

20720 AZKOITIA (SPAIN)

T :+34 943 85 13 27

Email : **iberdrill@erlogroup.es**